

ACCESSORY FITMENT INSTRUCTION

Product

Isuzu RT85 Fleet Sports bar Double Cab

Part no.

160022T (171)



40
Minutes

Models : SC

Page 1 of 6

Date : 12-Oct-2018

DIAGRAM

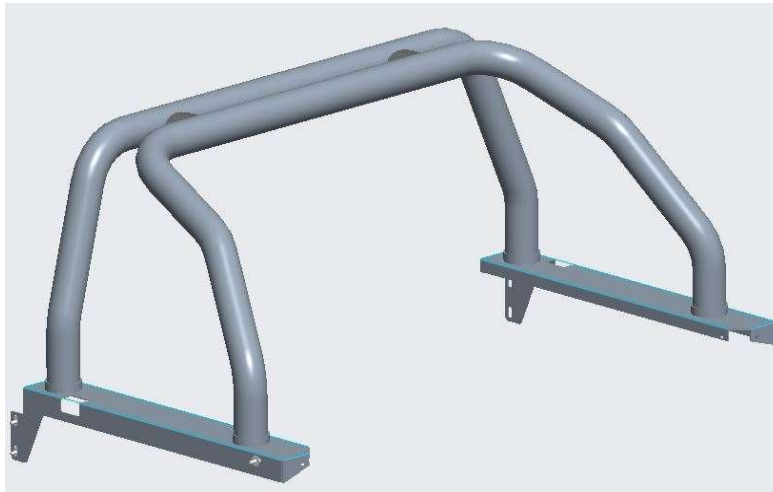

Kit content:

	Qty	Description		Qty	Description
A	2	M8x90 Sets	L	2	Load spread plates
B	2	M8 Spring washer	K	2	Top join rubbers
C	2	M8x25x2 FW	N	2	Grommets
D	4	M10x30x2,5 FW	O	4	Foot rubbers
E	4	M10 SW	P	1	Foront bar
F	4	M10 Hex nuts	Q	1	Rear bar
G	8	M8x22x1,5 FW			
H	8	M8x25 Sets			
I	8	M8 SW			
J	2	M8 Hex nuts			
K	2	Base plates			

Additional equipment/Material needed for fitment :

Qty		Socket and Ratchet Set	Qty		White Marker(Any Colour)
		Spanner Set			ø10mm Drill Bit
		Centre Punch			Hand Drill

Precautions during fitment:

Ensure that you are wearing appropriate PPE for the Following Fitment

Do Not cause any Damage to the vehicle

Requires 2 People to Fit

Directions for use:

Read all instructions Carefully before Fitting!

Fitment Instruction: Isuzu RT85 Sports bar Single Cab

Visual / Graphic Illustration

Step #

Description/Method

Figure 1

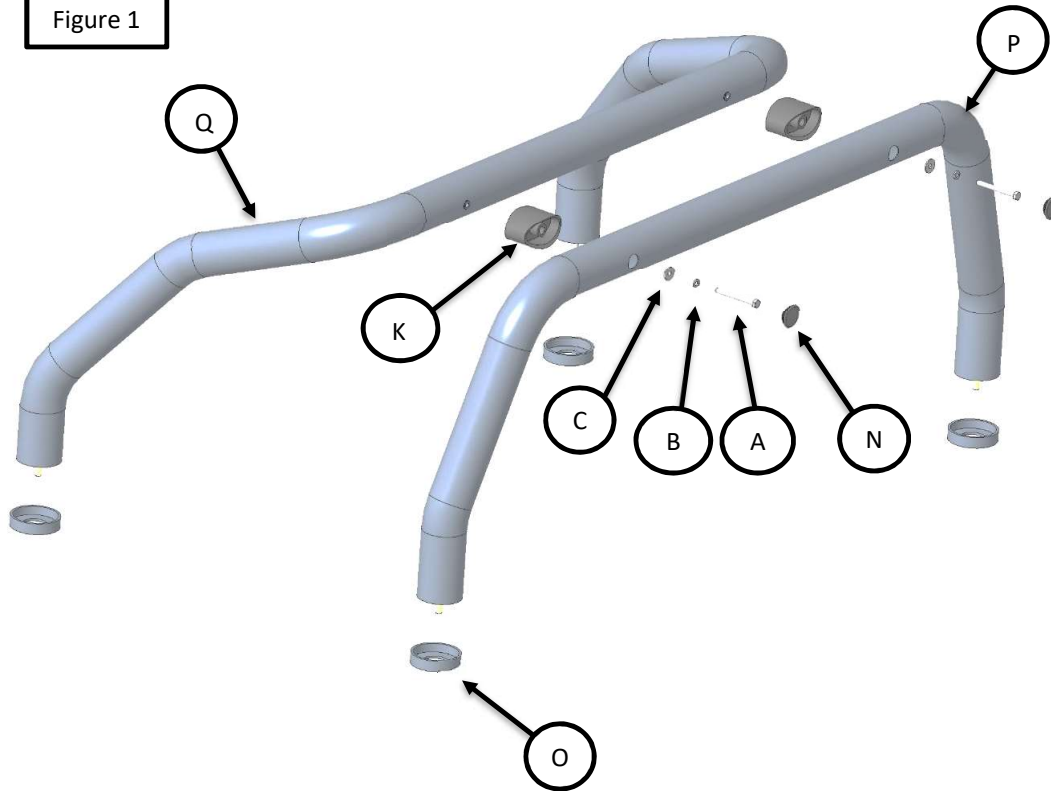

1

Assemble Sports Bar as shown in Figure 1.

Fitment Instruction: Isuzu RT85 Sports bar Single Cab

Visual / Graphic Illustration

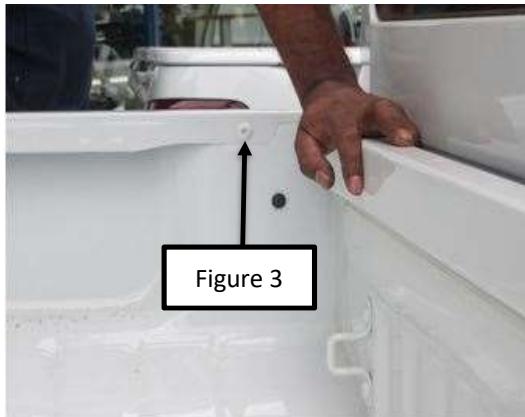
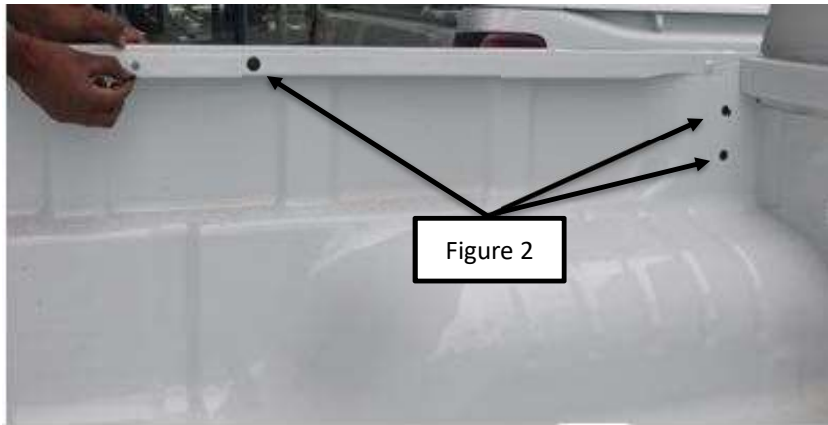

Step #

Description/Method

2

Remove the plastic grommets without damaging the paint work. NB: the two grommets near the header panel need to be unscrewed. These holes are the designated mounting points for the base to be fitted.

3

Do not open.

Fitment Instruction: Isuzu RT85 Sports bar Single Cab

Visual / Graphic Illustration

Step #

Description/Method



Figure 4

4

NB: bracket has been designed to accommodate the unwanted bolts for the fitment.



Figure 5

5

place base plates(k) in position and put on bolts loosely.

M8 bolt (H), M8 spring washer(I) and M8 flat washer (G).

Fitment Instruction: Isuzu RT85 Sports bar Single Cab

Visual / Graphic Illustration

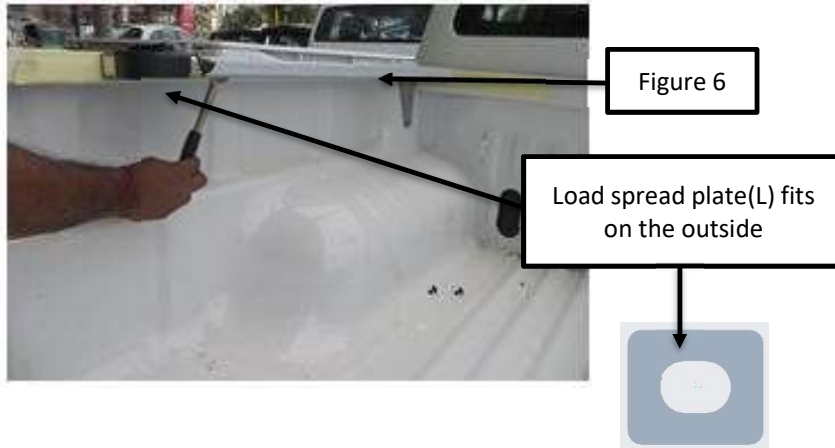

Step #

Description/Method

6

Line up base plate to the top of the bin and tighten.

7

M10 hex nut (KF), M10 spring washer(E) and a M10 flat washer(G).

8

Complete

Final step

Page 6 of 6

Make sure bar is centralised and tighten all fasteners to specified torque. M8= 22Nm , M10= 42Nm , M6= 9Nm.

