

ACCESSORY FITMENT

Product

Mahindra Scorpio Nudge Bar Black

Part no.

BS-130020, BS-130020RT,BS-130022 TN : 368



60
Minutes

Models : Mahindra Scorpio 2019

Page 1 of 5

Date : 27/11/19

DIAGRAM

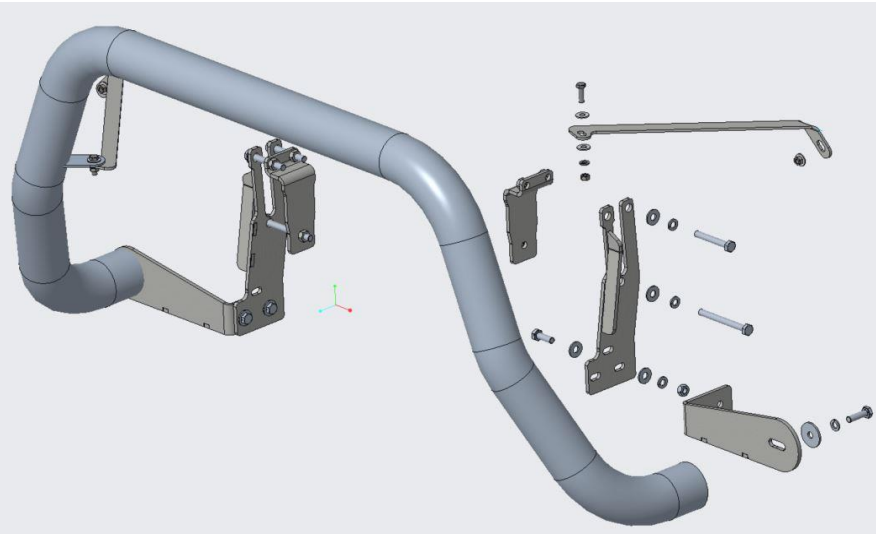

Kit content:

	Qty	Description		Qty	Description
A	2	M10x100 sets	I	4	M8x20x1.6 flat washers
B	4	M10x70 sets	J	2	M8 Spring washers
C	16	M10x25x2 Flat washers	K	2	M8 Hex nuts
D	6	M10 Hex nuts	L	4	Bottom bar brackets PS and DS (Welded)
E	6	M10x30 sets	K	2	Bottom brackets PS and DS (Welded)
F	14	M10 Spring washers	N	2	Top brackets PS and DS
G	2	M10x40x2.5 Flat washers	O	2	Clamping bracket PS and DS (Welded)
H	2	M8x25 sets	P	1	Nudge Bar

Additional equipment/Material needed for fitment :

Qty			
		Ratchet set	
		Spanner Set	
		Torque wrench	

Precautions during fitment:

Be carefull not to scratch the vehicle or the supplied parts during fitment.

Directions for use:

Follow the steps in this fitting instruction from step 1 - 5.

Fitment Instruction: Mahindra Scorpio Nudge Bar Black

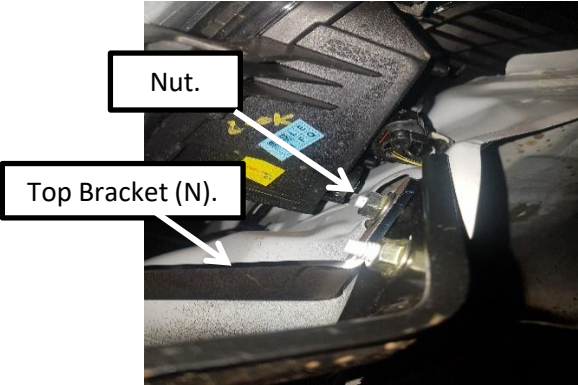
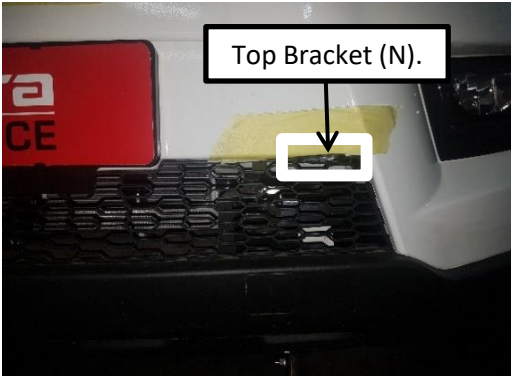
Visual / Graphic Illustration	Step #	Description/Method
<div style="display: flex; justify-content: space-around; align-items: center;"> <div style="text-align: center;"> <p>FIG 1</p>  </div> <div style="text-align: center;"> <p>FIG 2</p>  </div> </div>	<p>Step 1</p>	<p>Find the bolts needed to remove the wheel arch cover. Fig 1. Cover has been removed already, install the top brackets and the cover after complete.</p>
	<p>Step 2</p>	<p>Remove and reuse the nut shown in Fig 2 to install the top bracket.</p>
<div style="text-align: center;"> <p>FIG 3</p>  </div>	<p>Step 3</p>	<p>Do not cut the grill. Top bracket shown in Fig 3.</p>
		<p>Passenger Side Shown</p> <p>Do to both sides of the vehicle.</p>

Fitment Instruction: Mahindra Scorpio Nudge Bar Black

Visual / Graphic Illustration

Step #

Description/Method

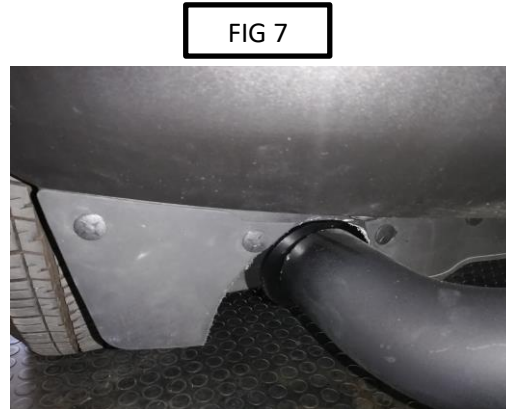
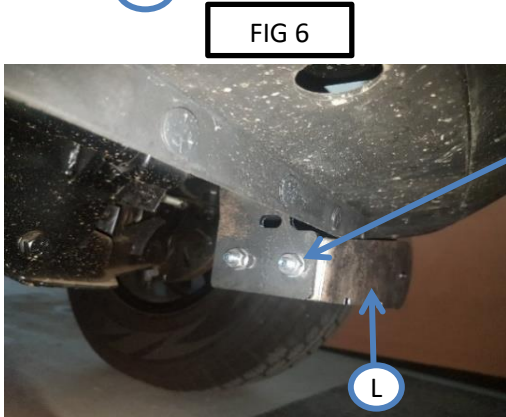
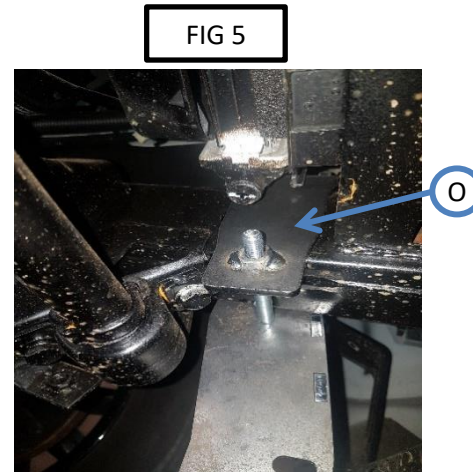
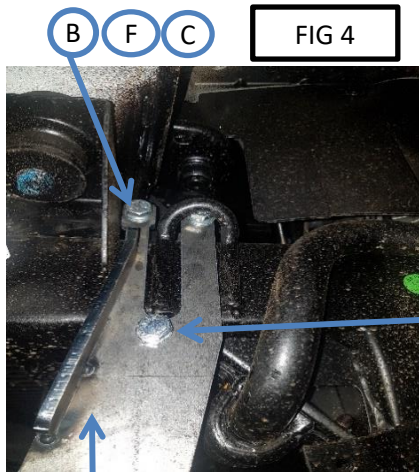

Step 4

Install bottom bracket using the bottom bracket (K) and the clamping bracket (O) as shown in Fig 4 and Fig 5.

Step 5

Install bottom bar bracket (L) , the bracket will have "P" marked on it. Shown in Fig 6.

NB

When fitting the S11-SUV please ensure that you make a cut out on the front splitter to allow the bar to mount to the bottom bracket without interference. As shown in FIG7.

Passenger Side Shown

Do to both sides of the vehicle.

Fitment Instruction: Mahindra Scorpio Nudge Bar Black

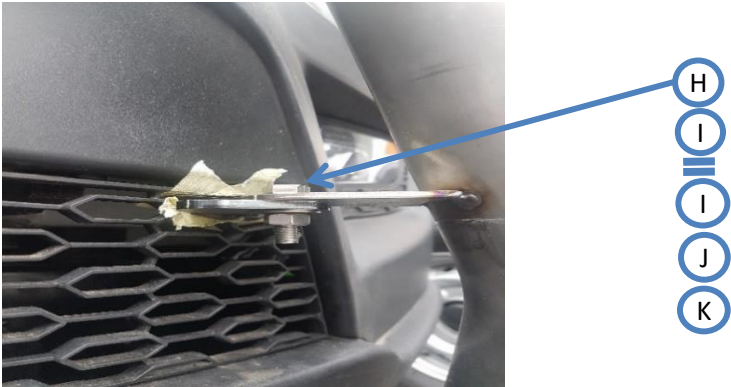
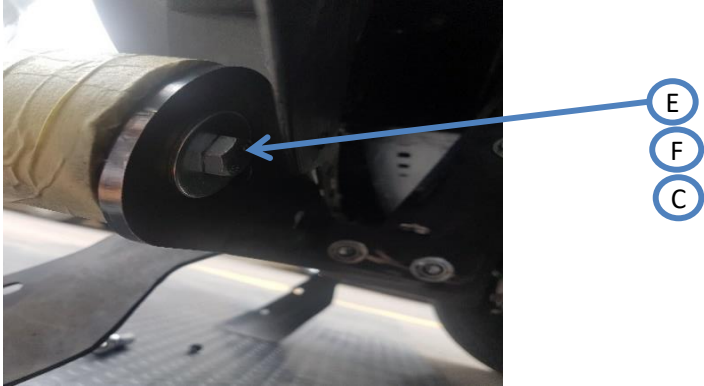
Visual / Graphic Illustration	Step #	Description/Method
<div style="text-align: center; border: 1px solid black; width: fit-content; margin: 0 auto; padding: 2px;">FIG 7</div> 	Step 6	Install nudge bar to the brackets that was installed in the previous steps and tighten all bolts and nuts as shown in Fig 7 and Fig 8.
<div style="text-align: center; border: 1px solid black; width: fit-content; margin: 0 auto; padding: 2px;">FIG 8</div> 		COMPLETE.