



## ACCESSORY FITMENT

**Product**

**RANGER SPORTS BAR**

**Product no:**

150043T



60  
Minutes

Models : DC, CC and SC

Page 1 of 5

Date : 07/12/2015

DIAGRAM



Kit content:

	Qty	Description		Qty	Description
A	2	LH + RH base plates	M	2	M8x25x2 Flat washer
B	2	M6x20 sets	N	1	Front sports bar
C	2	M6 Spring washers	O	1	Rear sports bar
D	2	M6 Flat washers	P	2	
E	6	M8x25 Sets	Q	2	Top mount rubbers
F	12	M8x20x1.6 Flat washers	R	4	Feet rubbers
G	6	M8 Spring washers	S	2	Grommet
H	6	M8 Hex nuts			
I	4	M10 Hex nuts			
J	4	M10 Spring washer			
K	4	M10x40x3 Flat washer			
L	2	M8x90 Set			

Additional equipment/Material needed for fitment :

Qty	1	Torque wrench	1	Measuring tape
	1	Spline key set	1	Centre Punch
	1	Drill + drill bits	1	Marking pen
	1	Tectyl		

Precautions during fitment:

**Do not scratch the vehicle during fitment. Do not scratch sports bar when unpacking and during fitment.**



# Fitment Instruction: RANGER SPORTS BAR

## Kit Contents

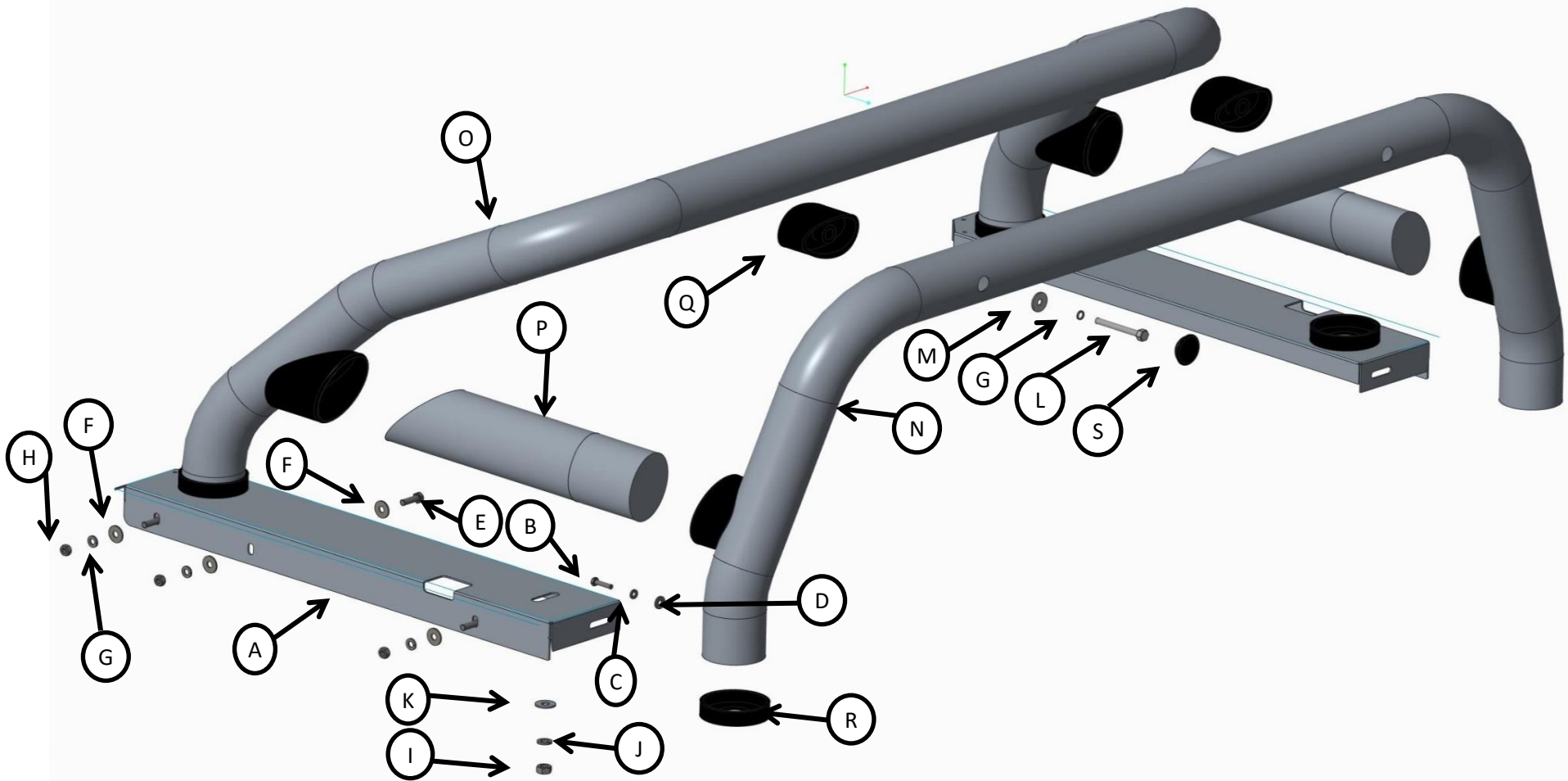



## Fitment Instruction: RANGER SPORTS BAR

### MARK, DRILL AND MOUNT



Fig1



Fig2

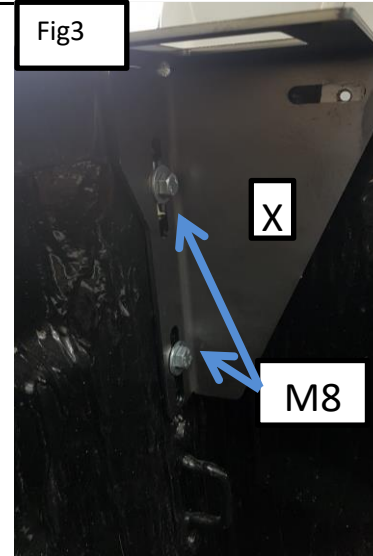

Fig3

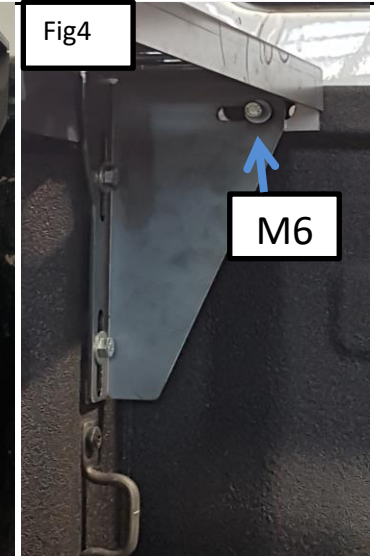

Fig4

#### Step 3.1

Place the passenger side base plate in the corner of the bin and mark the holes to be drilled. As shown in Fig 1

#### Step 3.2

Drill the holes to 9.5mm. As shown in Fig 2

#### Step 3.3

Attach the side support bracket(X) level to the bin, using the M8 fastners provided finger tighten the bracket on, ensure that you have a 2mm gap at the front the bracket . As shown in Fig 3

#### Step 3.3

Place the base plate over the support bracket, using the M6 fasteners provided sandwich the two brackets to the header panel. As shown in Fig 4

#### Step 3.3

Secure the base plate using the rest of the M8 fastners provided. Ensure that it is level with the side of the bin and torque all bolts. As shown in Fig 4



Fig5



### Fitment Instruction: RANGER SPORTS BAR

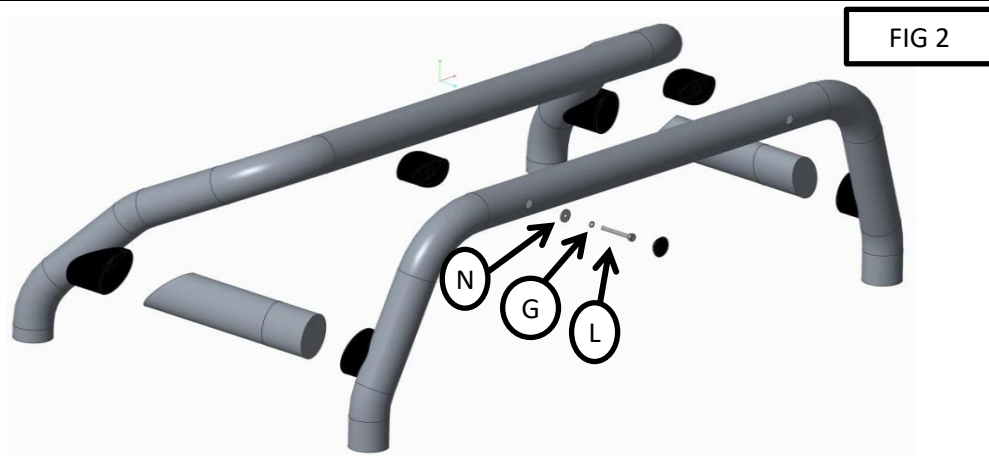

FIG 2

2

Pre-assemble the sports bar before mounting to base plates. FIG 2

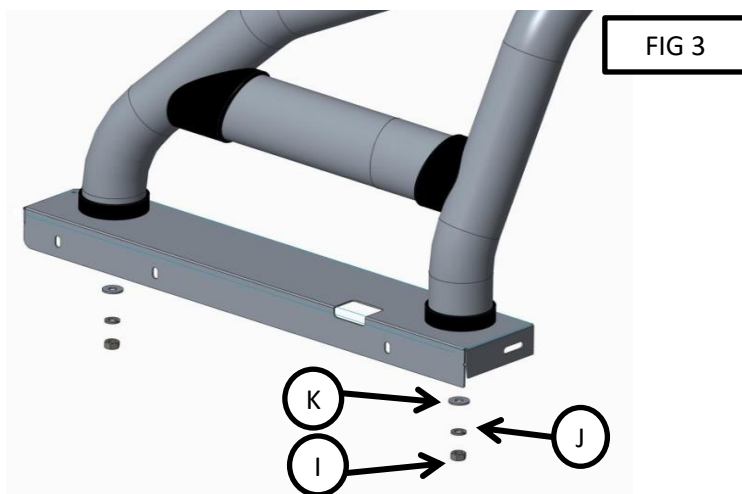

FIG 3

3

Place sports bar onto base plates and tighten using the KIT shown FIG 3.