

ACCESSORY FITMENT

Product

Haval P Series Sports Bar DC

Product No:

72057T/BS-72057 TN : 410



60
Minutes

Models : DC

Page 1 of 5

Date : 21/01/2121

DIAGRAM



Kit content:

	Qty	Description		Qty	Description
A	6	M8X25 SETS	L	2	Top Rubbers
B	6	M8X22X1.6 FLAT WASHERS	M	2	Foot Rubbers
C	6	M8 SPRING WASHERS (HD)	N	2	Side plates
D	4	M10 HEX NUTS	O	2	Grommets
E	4	M10x30x2.5 Flat washer	P	2	Corners Rubbers
F	4	M10 SPRING WASHERS	Q	2	3 inch side tube
G	2	M8X90 SETS	R	2	Base Plates - P
H	2	M8 SPRING WASHER			
I	2	M8X25X2 FLAT WASHERS			
J	2	M8 PLASTIC CAP COVER			
K	2	T Nuts			

Additional equipment/Material needed for fitment :

Qty	1	Spanner Set + extension	1	drill
	1	Torque wrench	1	9mm Drill bit
	1	masking tape	1	tectyl
	1	marking pen	1	Centre punch

Precautions during fitment:

Ensure you have an adequate working space. Requires two people for fitment. Ensure that the correct tools are used and be careful not to scratch the vehicle or parts.

Fitment Instruction:

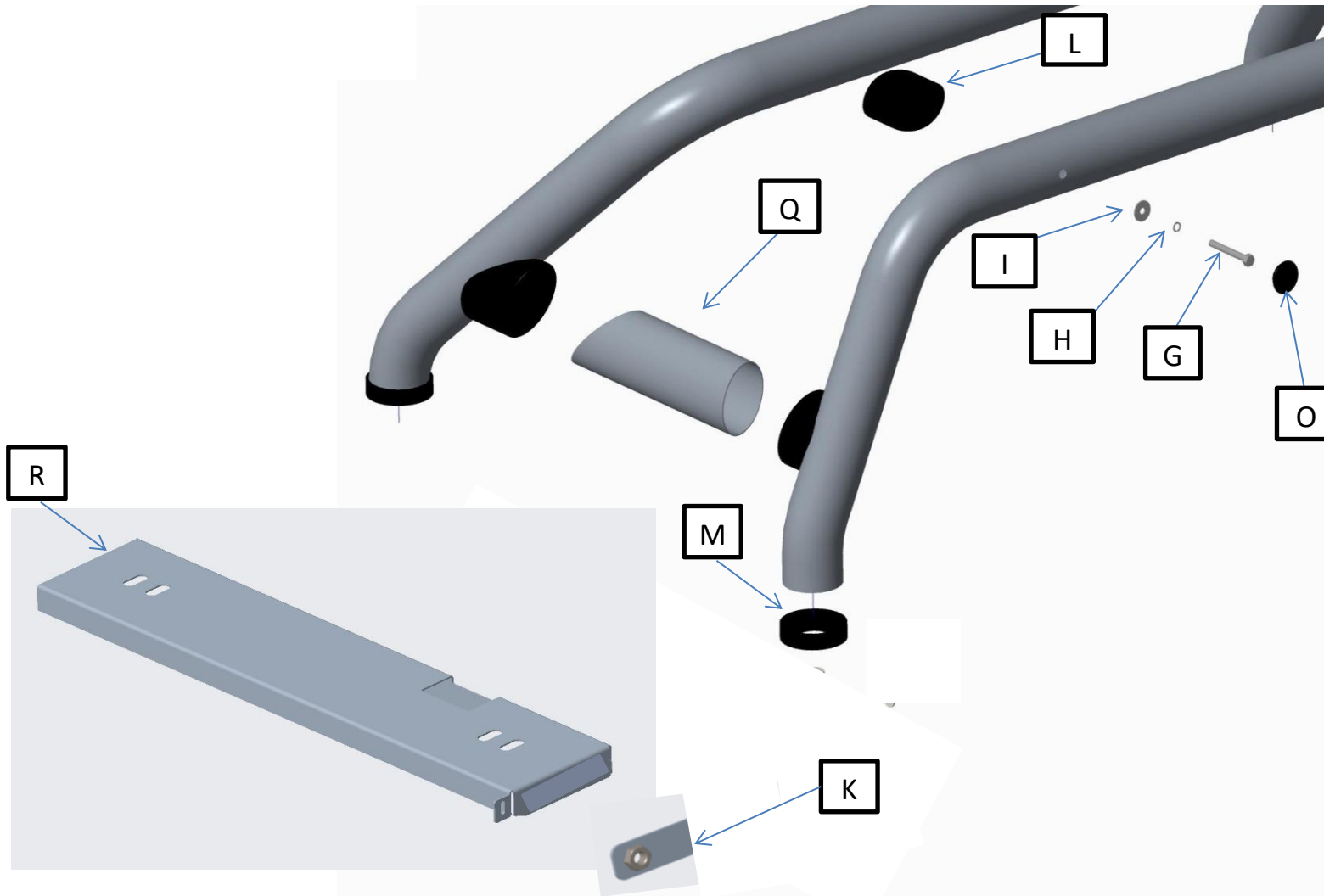

Fitment Instruction:

Haval DC Sports Bar

Visual / Graphic Illustration

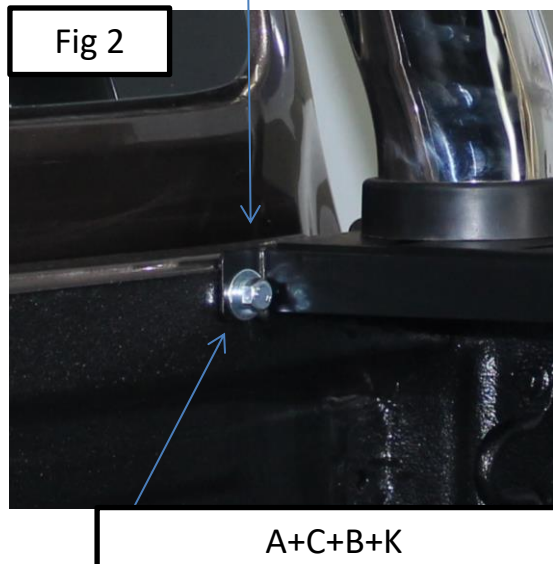
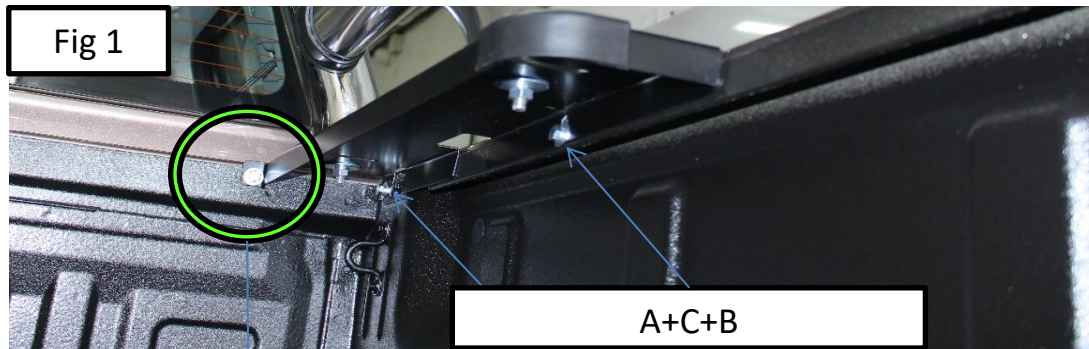

Step 1

Description/Method

Step 1.1

Remove the existing bolts on the side of the bin and using the fastners provided mount the base plate loosely onto the side, as shown in Fig 1.

Step 1.2

Using the side bolts to secure to base plate, level the base plate up and mark the front hole on the header panel highlighted within the ring and shown in FIG 2.

Step 1.3

Remove the base plate then centre punch the centre of the mark you made in step 1.2. Once centre punched you must drill through the bin plate using a 9mm drill bit. Be cautious not to drill through and damage the cab. Repeat steps 1.1-1.3 on the passenger side.

Step 1.4

You can now bolt the base plates onto the bin using both the holes you have just drilled and the existing ones. The required bolts and nuts are shown in Fig1 and Fig2. The front of the base plate uses a special t-nut as there is no space for a spanner.

Fitment Instruction:

Haval DC Sports Bar

Visual / Graphic Illustration

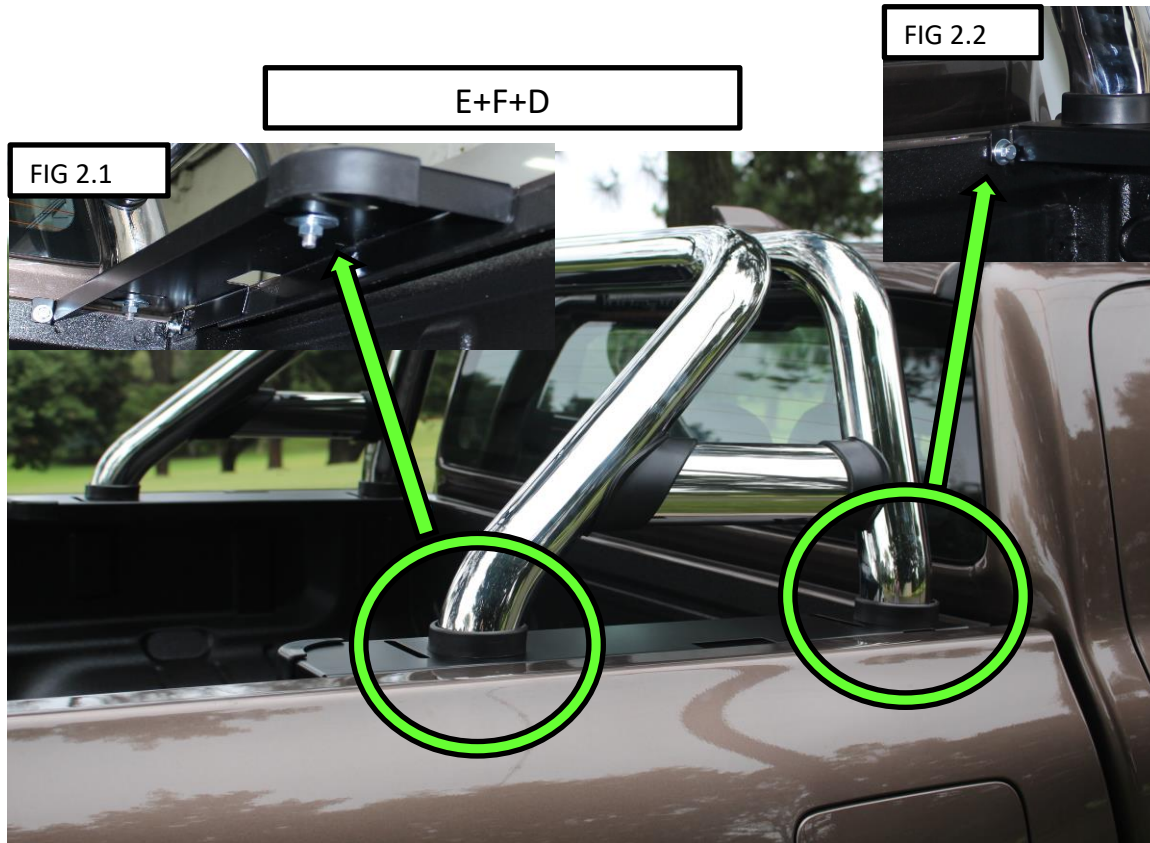

Step 2

Description/Method

Step 2.1

Assemble the sports bar as shown on page 2

Step 2.2

Mount the sports bar onto the base plates using the kit shown in Fig 2.1

Step 2.3

Place M8 plastic cap covers on all visible set screw shown in Fig 2.2.

COMPLETE

Make sure bar is centralised and tighten all fasteners to specified torque. M8= 22Nm , M10= 42Nm , M6= 9Nm.

