

# ACCESSORY FITMENT INSTRUCTION

**Product**

Isuzu MU-X 2022

**Part no.**

(1600072T) (Tracking No.: 428)



60  
Minutes

Models : 2021 +

Page 1 of 7

Date : 07-Feb-2022

## DIAGRAM

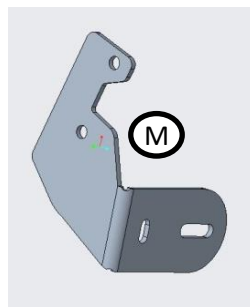
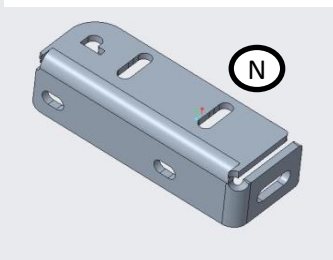
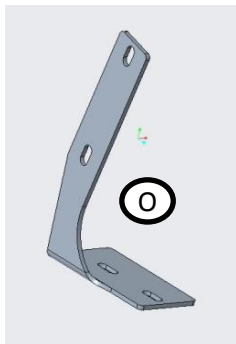

## Kit content:

|   | Qty | Description                |   | Qty | Description                         |
|---|-----|----------------------------|---|-----|-------------------------------------|
| A | 2   | M10 U- bolts               | L | 2   | M10 black hex caps                  |
| B | 4   | M10 x 30 set screws        | M | 2   | 1 x PS & 1 x DS bottom main bracket |
| C | 4   | M10 x 40 set screws        | N | 2   | 1 x PS & 1 x DS join brackets       |
| D | 10  | M10 Hex nuts               | O | 2   | 1 x PS & 1 x DS drop down brackets  |
| E | 18  | M10 x 30 x 2 flat washers  | P | 1   | Nudge bar                           |
| F | 12  | M10 spring washers         | Q |     |                                     |
| G | 8   | M8 x 25 set screws         | R |     |                                     |
| H | 12  | M8 x 22 x 1.6 flat washers |   |     |                                     |
| I | 8   | M8 spring washers          |   |     |                                     |
| J | 4   | M8 hex nuts                |   |     |                                     |
| K | 4   | M8 black hex caps          |   |     |                                     |

| Qty |  |                      | Qty |          |
|-----|--|----------------------|-----|----------|
|     |  | RATCHET & SOCKET SET |     | HACK SAW |
|     |  | MASKING TAPE         |     |          |

## Precautions during fitment:

Do not cause any damage to the vehicle. Apply masking Tape to the front bumper prevent any scratches. Requires 2 people to fit. Ensure that you are wearing the appropriate PPE during Fitment.

## Directions for use:

Read all instructions carefully before installation

## Fitment Instruction:

### MU-X Nudge bar

Visual / Graphic Illustration

Step #

Description/Method

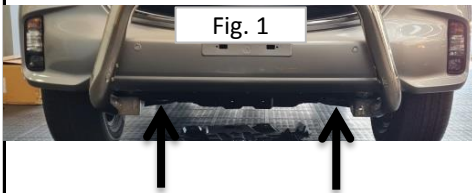

Plastic  
Undercover



Plastic Side Undercovers (PS & DS)  
*These covers are Trimmed (Trimming  
Instructions on next Page)*

1

Remove Front Plastic Under cover and Side Under Covers as shown in Figure 1, Figure 2 & Figure 3.

## Fitment Instruction:

### MU-X Nudge bar

Visual / Graphic Illustration

Step #

Description/Method

Fig. 4

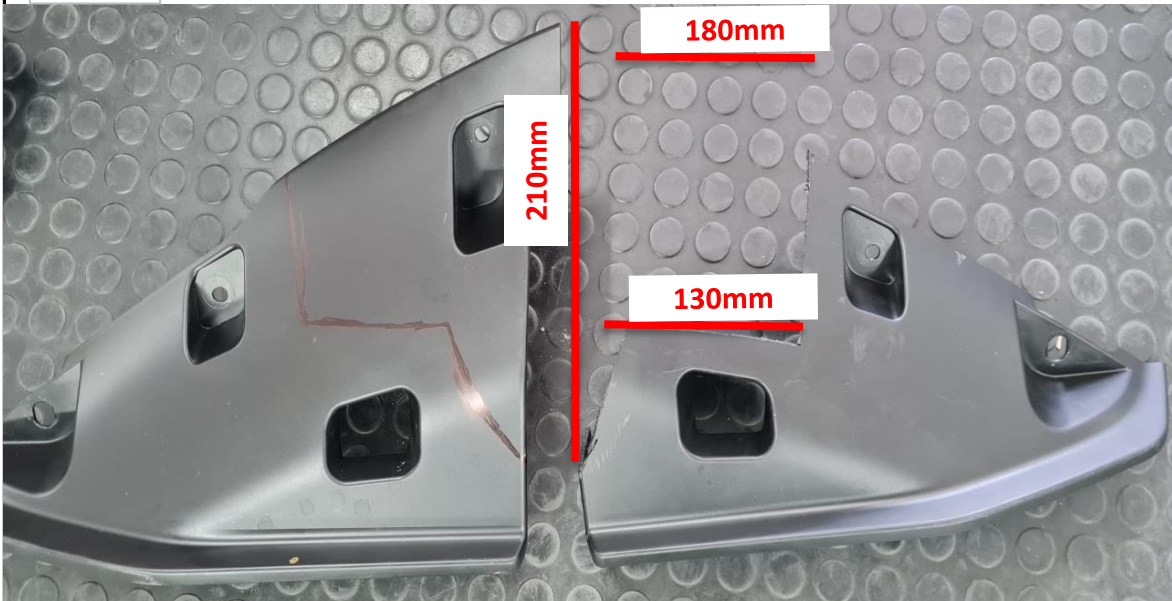

2

Locate Driver's Side Front Mud Cover as shown in Figure 4 & Figure 5.

3

Trim Front coverS as shown in Figure 4 & 5.

Fig. 5



4

Do the same to the passenger side of vehicle

## Fitment Instruction:

### MU-X Nudge bar

#### Visual / Graphic Illustration

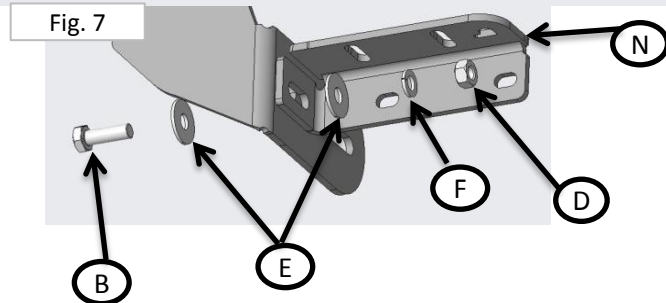
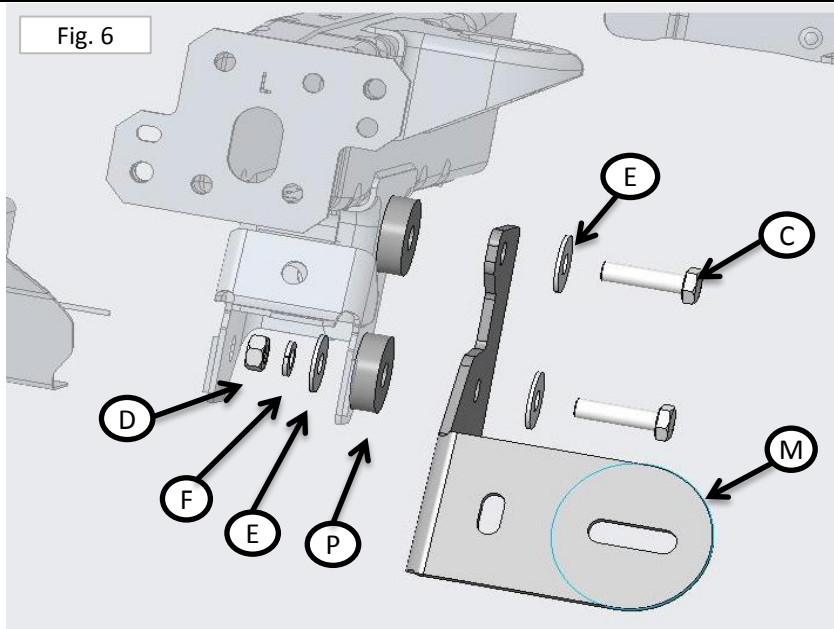

#### Step #

#### Description/Method

5

Locate PS Mounting Position on Chassis as shown in Figure 6

6

Fit PS Brackets with markings "P" as shown in Figure 6, Figure 7. Do not fully tighten yet.

## Fitment Instruction:

### MU-X Nudge bar

#### Visual / Graphic Illustration

Fig. 8

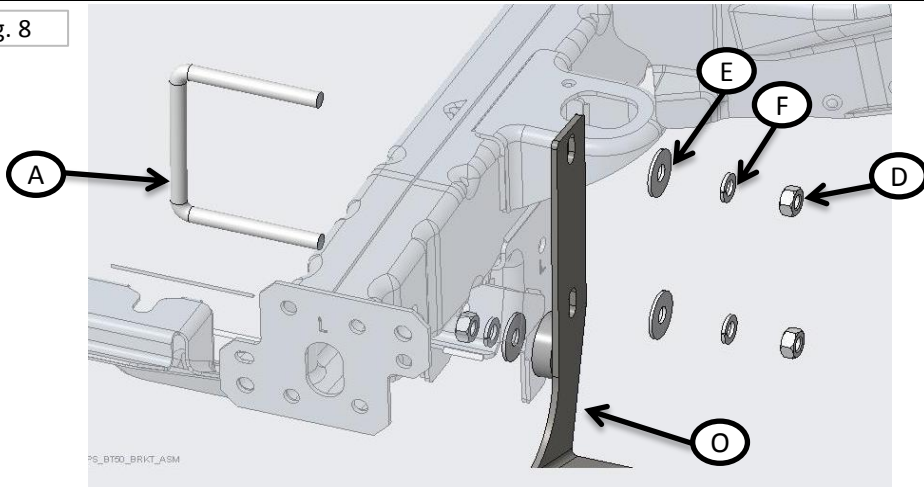

Fig. 9

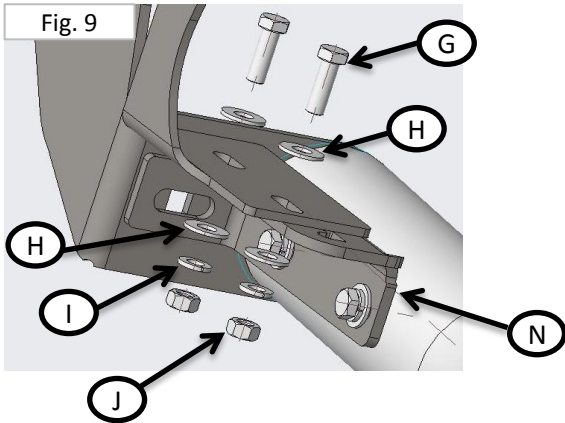
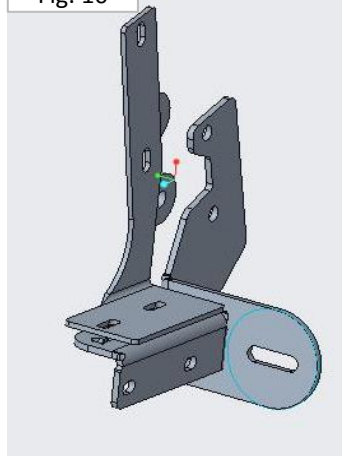

Fig. 10



#### Step #

#### Description/Method

7

Fit bracket "O" using the U bolt to the chassis s shown in Fig 8 and attach the bottom to Bracket N Using the M8 hardware as shown in Figure 9.

8

Figure 10 shows bracket assembly

Now mount the Drivers side following the same process as above



## Fitment Instruction:

### MU-X Nudge bar

#### Visual / Graphic Illustration

Fig. 11

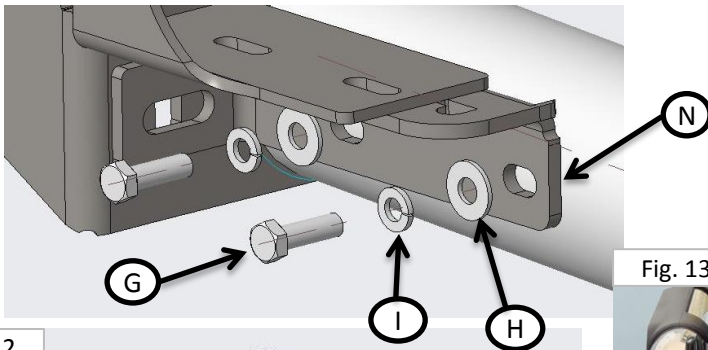

Fig. 12

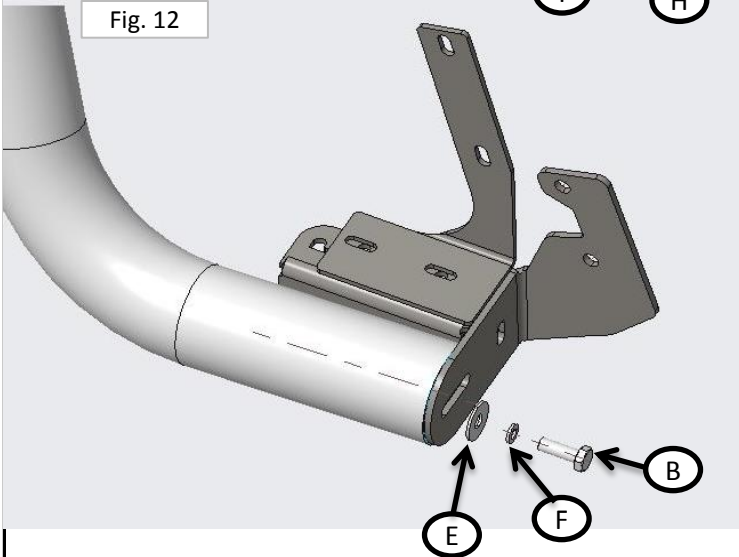

Fig. 13



#### Step #

#### Description/Method

Once you have both side brackets mounted proceed to step 9 below

9

Place Nudge bar to brackets and assemble as shown in Figure 11 & 12.

11

Ensure Nudge is centre and lift Nudge bar so there is a 10-12mm gap ( Figure 13) between bar and bumper then fully tighten.

## Final step

Page 7 of 7

Make sure bar is centralised and tighten all fasteners to specified torque. M8= 22Nm , M10= 42Nm , M6= 9Nm.

