

# ACCESSORY FITMENT INSTRUCTION

**Product**

Mahindra XUV300 Nudge bar

**Part no.**

130012T



60  
Minutes

Models : XUV 300

Page 1 of 5

15-06-2022

## DIAGRAM

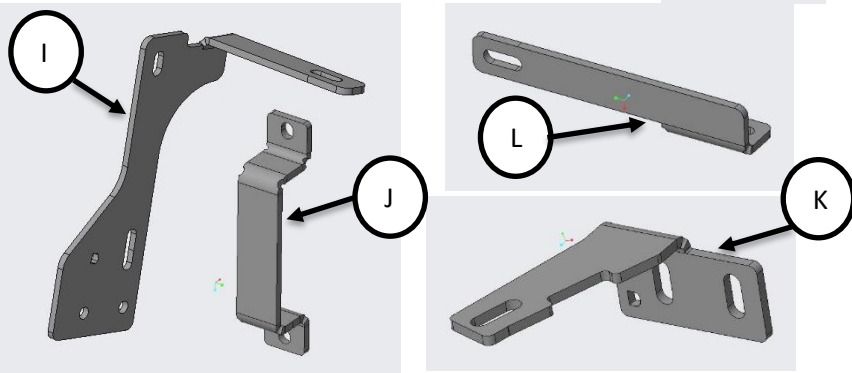
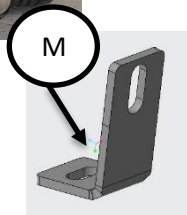

## Kit content:

	Qty	Description		Qty	Description
A	8	M8 x 25 set screws	H	4	Nut caps
B	12	M8 Flat washers	I	2	DS & PS Main Bracket
C	8	M8 spring washers	J	2	Clamp brackets
D	8	M8 hex nuts	K	2	DS & PS bottom bracket
E	8	M8 x 25 Stainless steel set screws	L	2	DS & PS Bottom Join Bracket
F	12	M8 Stainless steel flat washers	M	2	Top Join Brackets
G	8	M8 Stainless steel spring washers	N	1	Nudge bar

Qty	Socket set	Qty	
	Spanner set		
	Masking Tape		
	Measuring tape		
	Marker		

## Precautions during fitment:

Keep Bumper in a safe space when removed

## Fitment Instruction:

### XUV 300

Visual / Graphic Illustration

Step #

Description/Method

**1**

Remove Bumper from Vehicle

**2**

Find middle of the Crossbar and assemble brackets as shown in Fig 1 &amp; 2. Drivers Side shown in Fig 1 , Passenger Side is a mirror image.

**3**

Once brackets are in position , tighten brackets and replace bumper on vehicle.

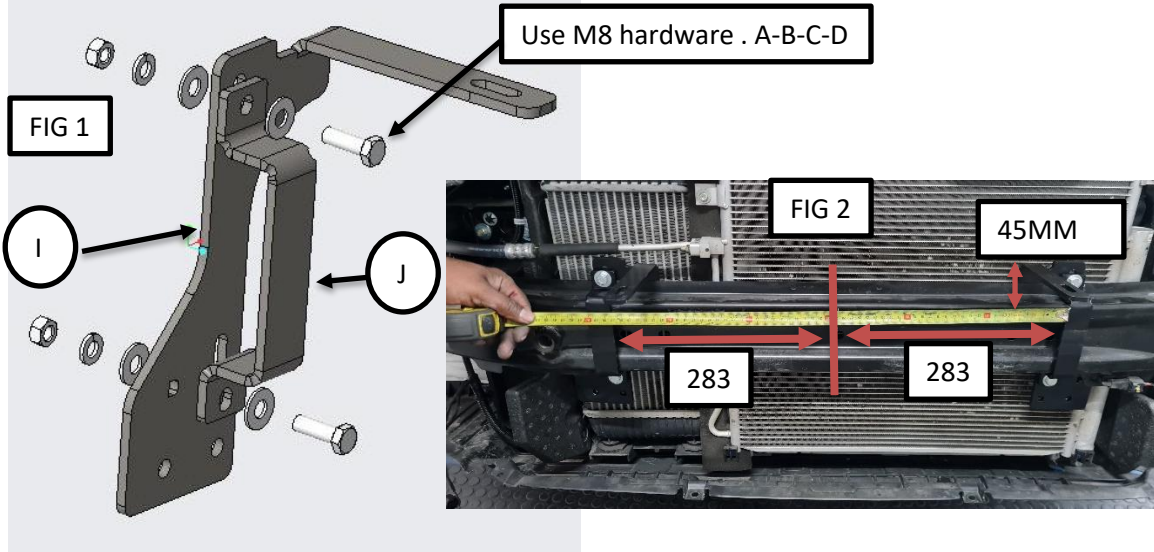

## Fitment Instruction:

### XUV 300

Visual / Graphic Illustration

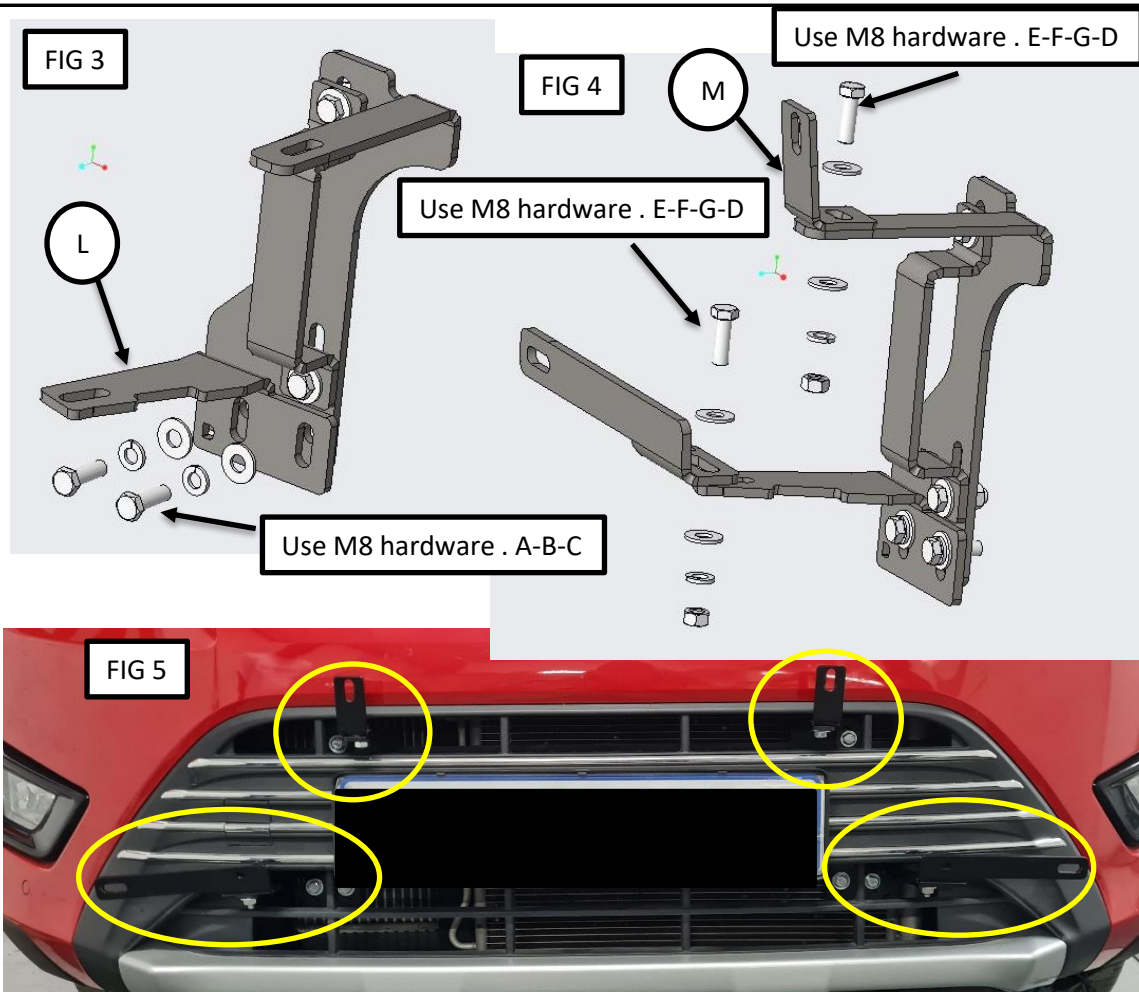

Step #

Description/Method

4

With Bumper now in place , you can assemble the rest of the Brackets as shown in Fig 3 to Fig 5. NOTE: Bracket "L" can be placed in position through the bumper.

## Fitment Instruction: XUV 300

Visual / Graphic Illustration

Step #

Description/Method

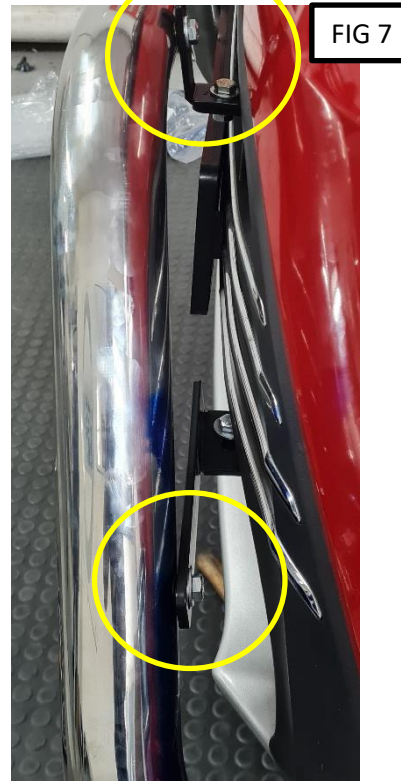
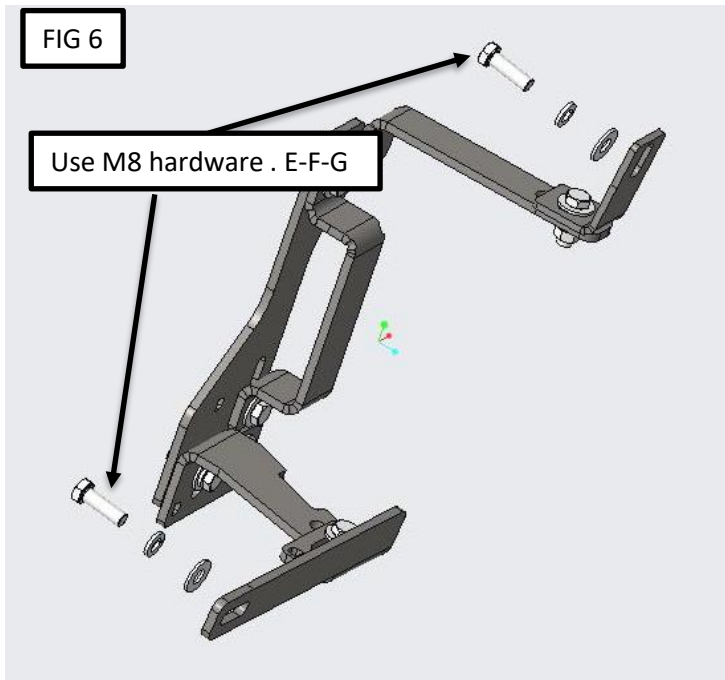

**5**

You can now attached the Nudge bar to the brackets as shown in Fig 6 & 7.

## Final step

Page 5 of 5

Make sure bar is centralised and tighten all fasteners to specified torque. M8= 22Nm , M10= 42Nm , M6= 9Nm.

