

# ACCESSORY FITMENT

**Product**

Ford Raptor Next GEN Sports Bar

**Part no.**

150059 TN : 492



60  
Minutes

Models : DCAB

Page 1 of 9

Date :08/03/2023

DIAGRAM



**Kit content:**

	Qty	Description		Qty	Description
A	12	M8 x 25 Sets	P	6	M8 x 40 sets
B	26	M8 x 20 x 1.6 Flat washers	Q	6	M8 plastic caps
C	28	M8 Spring washers	R	8	CSK black caps
D	8	M8 Hex nuts	S		
E	8	M8 x 45 CSK set screws	T		
F	2	M8 x 90 Set screws	U		
G	2	M8 x 25 x 2 Flat washers	V		
H	6	Grommets	W		
I	2	Base plates (P & D)	X		
J	4	Load spread plates	Y		
K	2	Top mount joining rubbers			
L	2	Side tubes			
M	4	Base rubbers			
N	8	Spacer tubes			
O	2	Side plate (P & D)			

**Additional equipment/Material needed for fitment :**

Qty		Spanner Set + extension		Screwdriver set
		Torque wrench		Stanley knife
		Measuring Tape		Allen Key set

**Precautions during fitment:**

Ensure you have an adequate working space. Requires two people for fitment. Ensure that the correct tools are used with installation. Read through the fitting instructions carefully before installation.

**Fitment Instruction:****Ranger Sports Bar**

Visual / Graphic Illustration

Step #

Description/Method

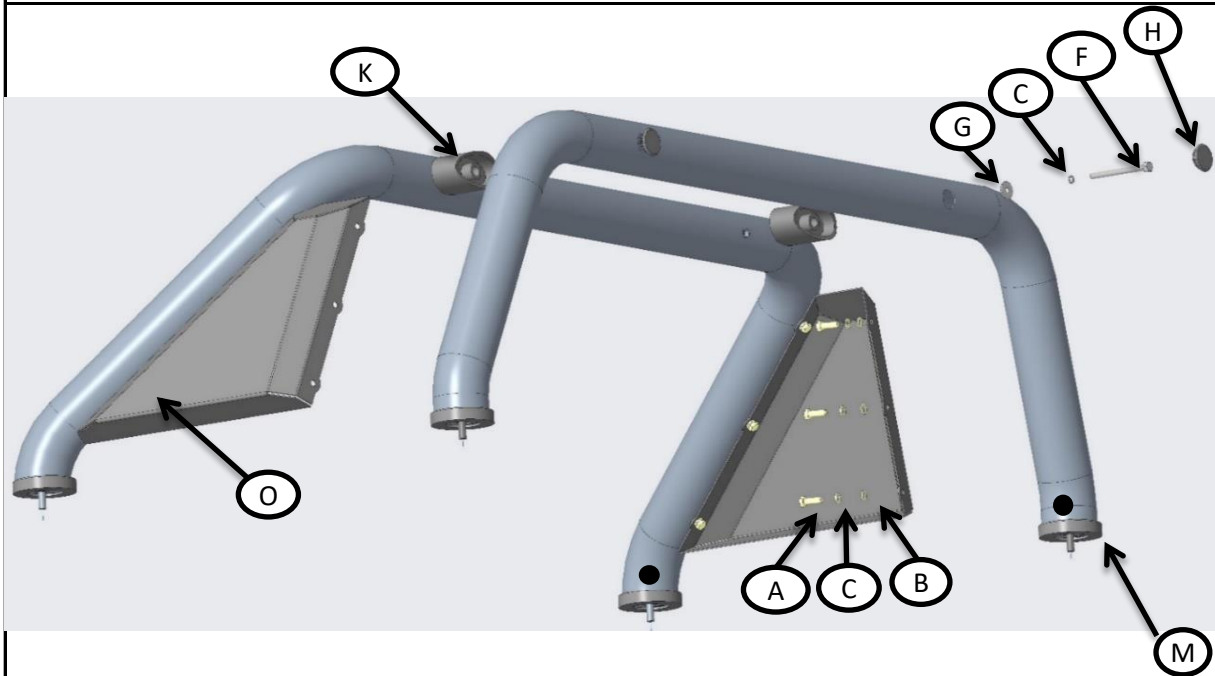

Assemble Sports Bar As  
Shown before installation

1

Assemble the sports bar using the fastners provided.

## **Fitment Instruction:**

### **Ranger Sports Bar**

Visual / Graphic Illustration

Step #

Description/Method

2

Gently remove the front and middle plastic cap to reveal mounting holes underneath

Rear of Vehicle

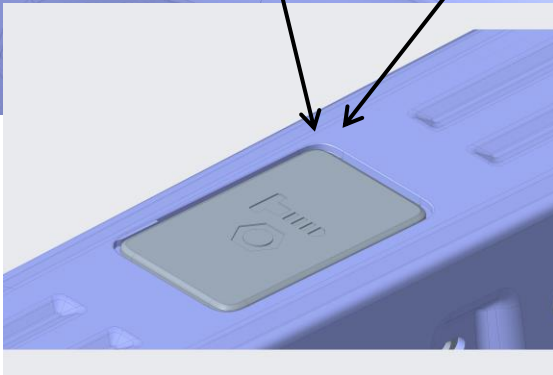

## **Fitment Instruction:**

### **Ranger Sports Bar**

Visual / Graphic Illustration

Step #

Description/Method

Fig 1

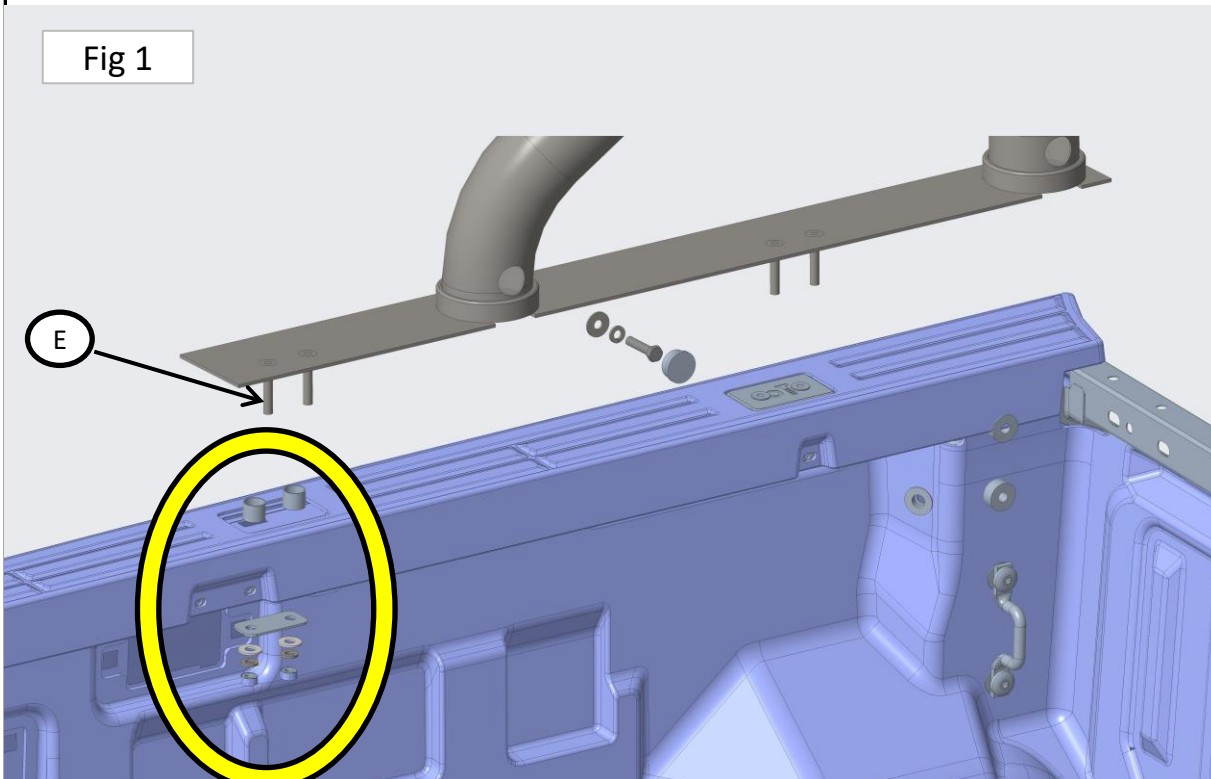

3

Loosley mount the Base Plate on to side using the hardware shown in Fig 1 and 2

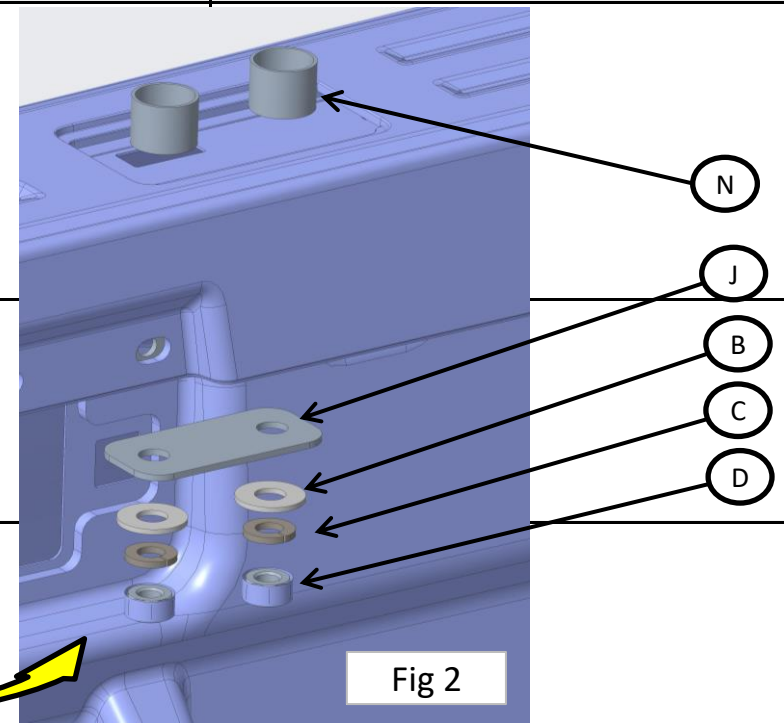

Fig 2

**Fitment Instruction:**

**Ranger Sports Bar**

Visual / Graphic Illustration

Step #

Description/Method

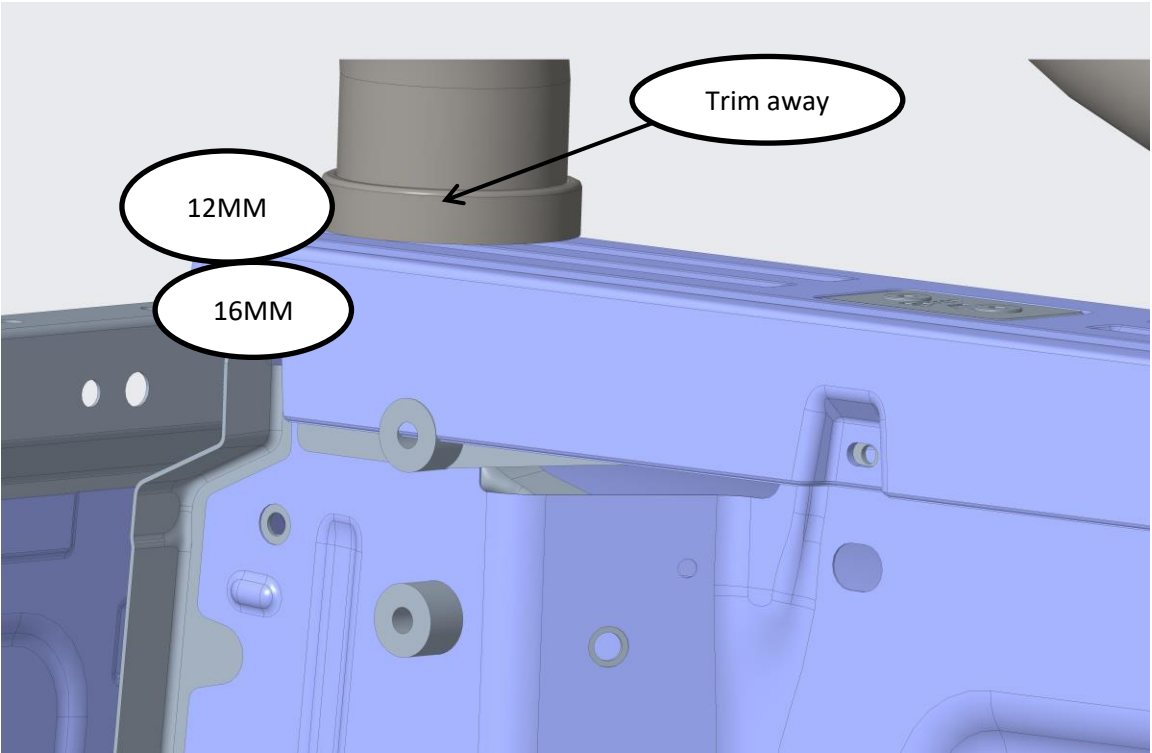

4

Using the 12 mm and 16 mm spacers provided, you can now mount the front bracket. Begin by making a slight trim around the 12mm spacer using a Stanley knife. Once you are done the spacer should fits flush.



## Fitment Instruction:

Page 6 of 9

### Ranger Sports Bar

Visual / Graphic Illustration

Step #

Description/Method

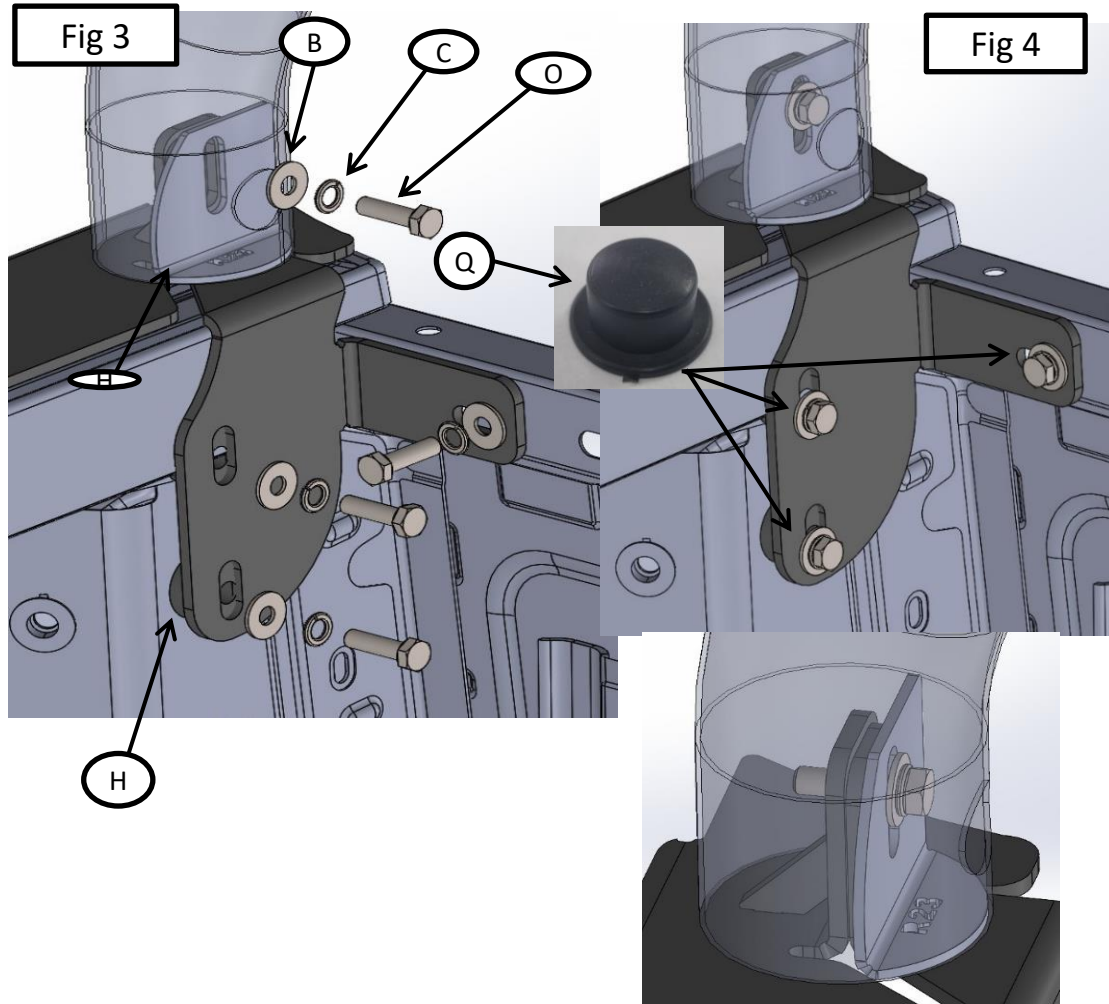

5

Install the Corner Brackets as shown in Fig 3 & 4.  
(Passenger side shown) Do not Tighten Fully yet. The M8 Bolt Cap(Q) will only be required at the end of the fitment, after you have the bar secured.

# Fitment Instruction:

## Ranger Sports Bar

Visual / Graphic Illustration

Step #

Description/Method

4

Once the base plate has been loosely mounted, place the assembled bar onto the base and using the fasteners below, loosely mount the entire bar to the base plates. The grommet(H) and the CSK cap(R) will only be required at the end of the fitment, after you have the bar secured.

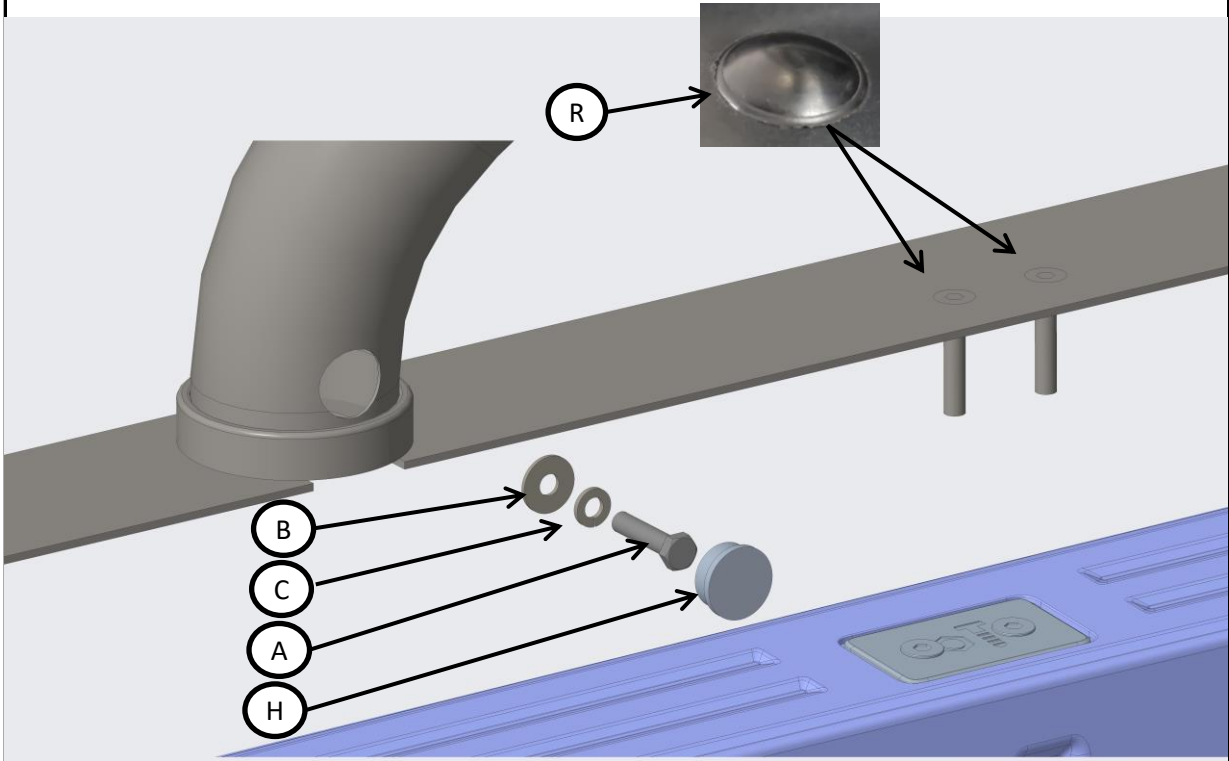

**Fitment Instruction:**  
Ranger Sports Bar

Visual / Graphic Illustration



Step #

Description/Method

5

Once the bar is placed correctly, you can begin to tighten the side plates, then the base plate next and finally you can tighten the bar onto the base plate.

6

Do not forget to fit the grommets(H) into the bar.



## Final step

Page 9 of 9

Make sure bar is centralised and tighten all fasteners to specified torque. M8= 22Nm , M10= 42Nm , M6= 9Nm.

