

ACCESSORY FITMENT

Product

JAC T9 Sports bar

Part no.

40013T, BS-40013



60
Minutes

Models : DC - T9

Page 1 of 5

Date : 31/10/2023

DIAGRAM



Kit content:

	Qty	Description		Qty	Description
A	10	M8x25 Sets	N	2	Grommets
B	18	M8x20x1.6 flat washer	O	2	Corner rubbers
C	10	M8 Spring washers	P	2	Side tubes
D	8	M8 Hex nuts	Q	2	M8 T - Nuts
E	4	M10 Hex nuts			
F	4	M10 Spring washers			
G	4	M10x40x3 Flat washers			
H	2	M8x90 Sets			
I	2	M8 Spring washer			
J	2	M8x25x2 Flat washer			
K	2	Base plates			
L	4	Base rubbers			
M	2	Joining rubbers			

Additional equipment/Material needed for fitment :

Qty		Qty	
	Spanner Set		Stanley Knife
	Screw driver Set		Torque wrench
	Socket Set		

Precautions during fitment:

Ensure you have an adequate working space. Requires two people for fitment. Ensure that the correct tools and appropriate PPE are used with installation.

Fitment Instruction: JAC T9 Sports bar Stainless

Visual / Graphic Illustration

Fig 1

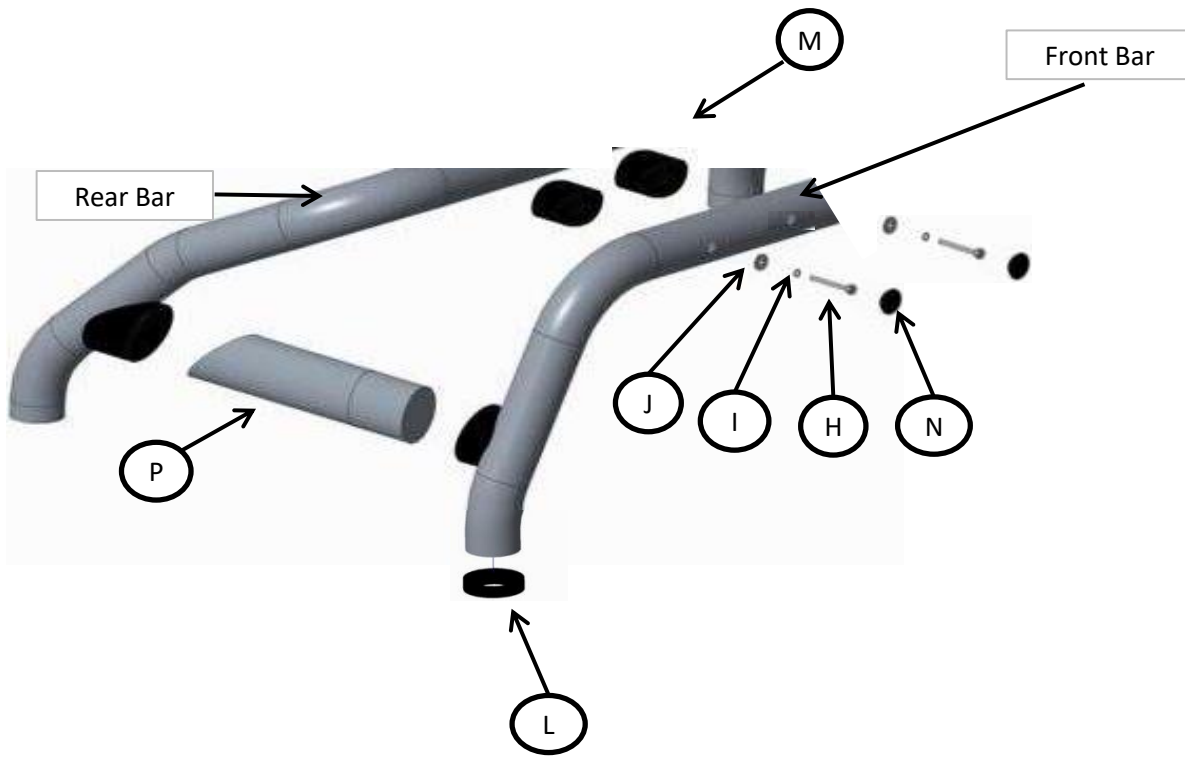

Step #

Description/Method

1

Assemble the Sports bar as shown in Fig 1.

Fitment Instruction: JAC T9 Sports bar Stainless

Visual / Graphic Illustration

Fig 2

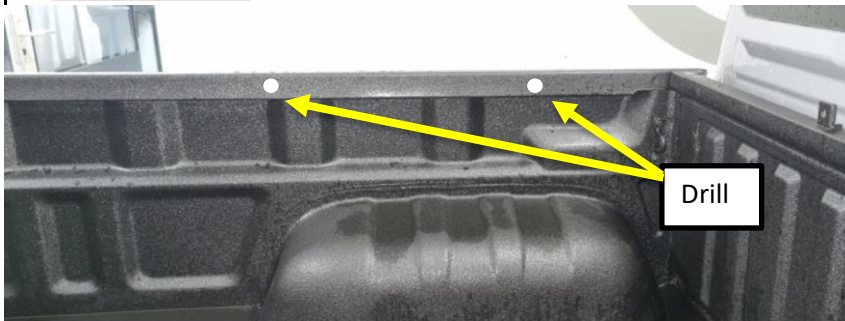
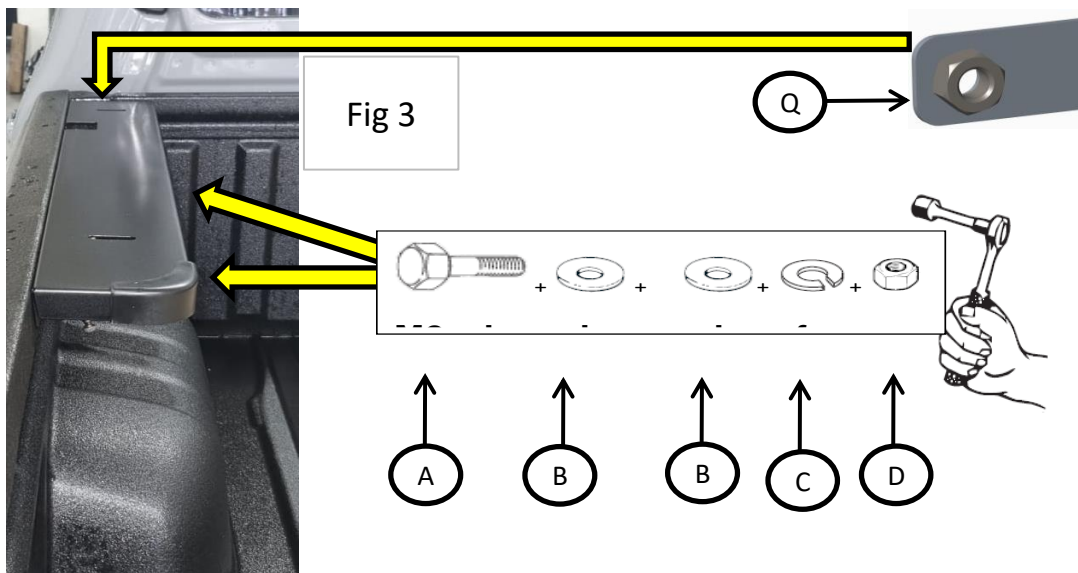

Fig 3



Step #

Description/Method

2

Place the base plate in position, mark the holes and proceed to drill a 9mm holes with caution. As shown in Fig 2.

3

Using the fasteners provided to secure the base plate as shown in Fig 3 (NB: There is a T-Nut(Q) provided to mount the base plate to the header panel as shown in Fig 3).

4

Repeat instructions 2 & 3 to the Driver's side.

Fitment Instruction: JAC T9 Sports bar Stainless

Visual / Graphic Illustration

Step #

Description/Method

Fig 4

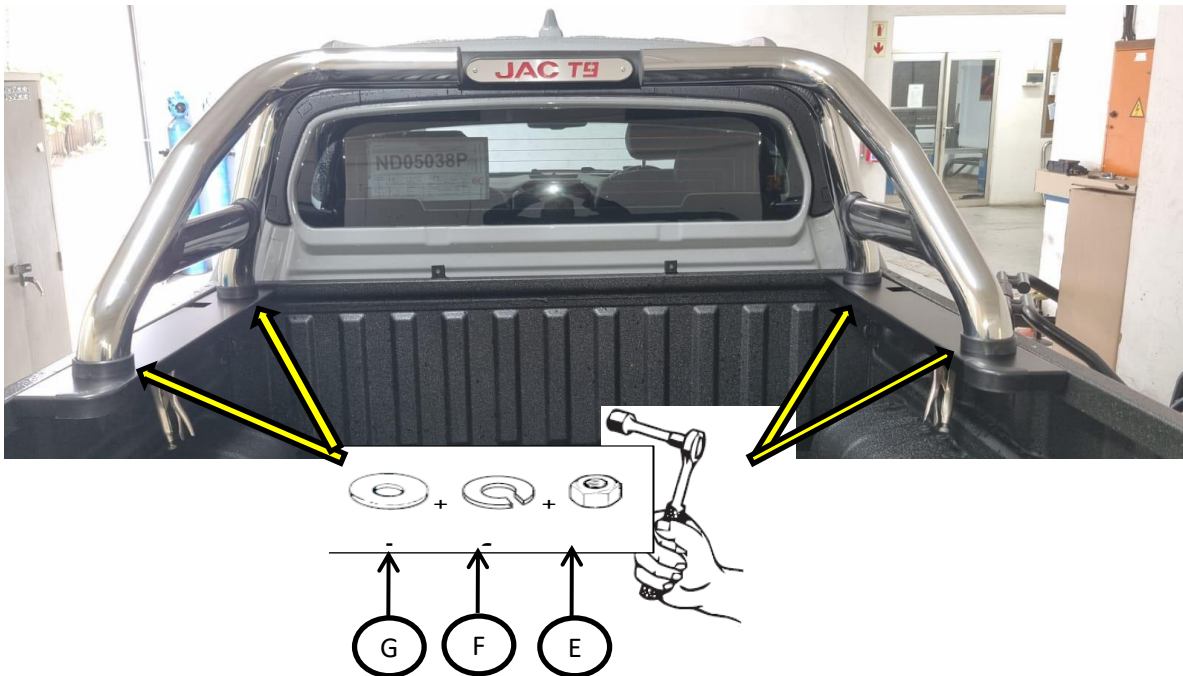

5

Gently place the bar into position and secure the bar using the fasteners provided.

Final step

Make sure bar is centralised and tighten all fasteners to specified torque.
M8= 22Nm , M10= 42Nm , M6= 9Nm.

