

ACCESSORY FITMENT INSTRUCTION

Product

Suzuki Jimny Side Bars

Part no.

120013T ,BS-120013 , 9900L-80TSI-BLK/SID



60
Minutes

Models : All

Page 1 of 6

Date : 21-09-2022

DIAGRAM



Kit content:

	Qty	Description		Qty	Description
A	2	M10 Set Screw, 35mm Long	J	2	M6 Spring Washer
B	6	M10 Flat Washer, ø25 x 2mm THK	K	2	M6 Hex Nut
C	6	M10 Spring Washer	L	2	Front Bracket (PS & DS)
D	6	M10 Hex Nut	M	2	Rear Bracket (PS & DS)
E	8	M8 Set Screw, 25mm Long	N	2	M6 T-Bolt, 40mm Long
F	16	M8 Flat Washer, ø25x 2mm THK	O	2	M10 U-Bolt
G	8	M8 Spring Washer	P	2	Spacer, ø50 x 4mm THK
H	8	M8 Hex Nut	Q	2	Spacer, ø35 x 10mm THK
I	2	M6 Flat Washer, ø25 x 2mm THK	R	2	Side Step (PS & DS)

Additional equipment/Material needed for fitment :

Qty		Qty	
	Spanner Set		Masking Tape
	Socket and Ratchet Set		

Precautions during fitment:

Apply Masking Tape to the Side Sill of the vehicle to avoid scratches

Directions for use:

Read all Instructions carefully before installation.

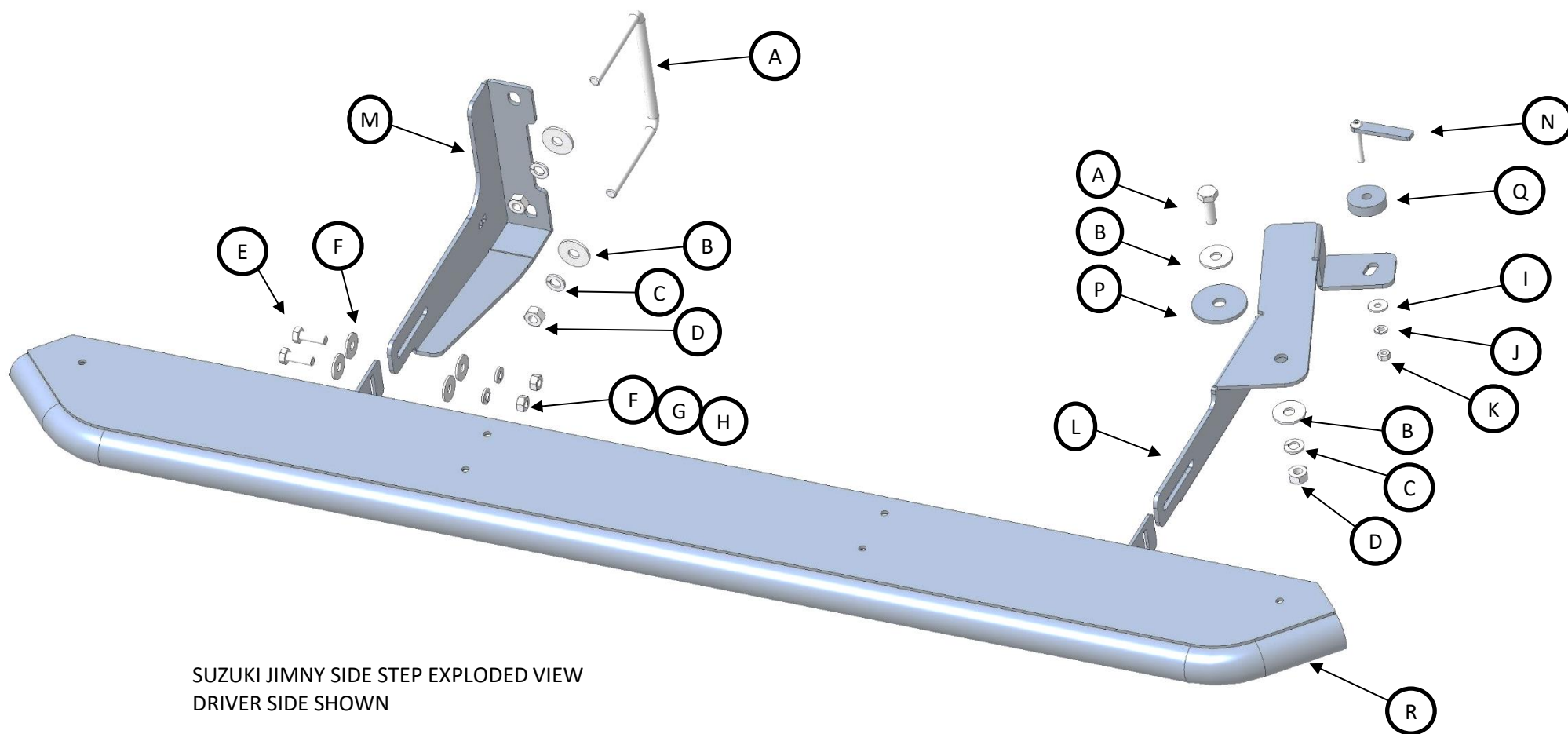

SUZUKI JIMNY SIDE STEP EXPLODED VIEW
DRIVER SIDE SHOWN

Note: Product Images in the Fitting Instruction might differ from actual product

Fitment Instruction: Suzuki Jimny Side Bars

Visual / Graphic Illustration

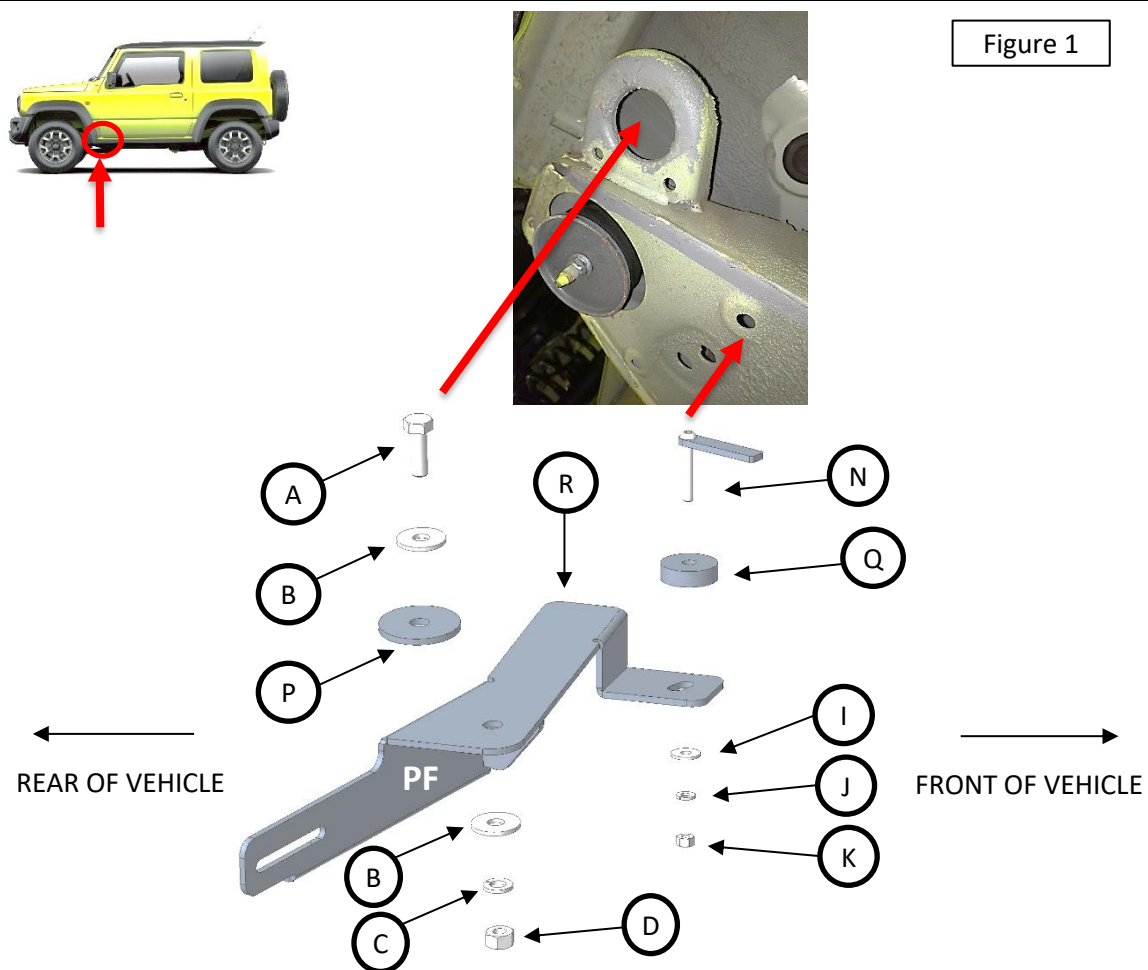

Step

Description/Method



1

Fit the Front Passenger Side Bracket as shown in Figure 1.

2

Do the same to the other side of the vehicle.

Fitment Instruction: Suzuki Jimny Side Bars

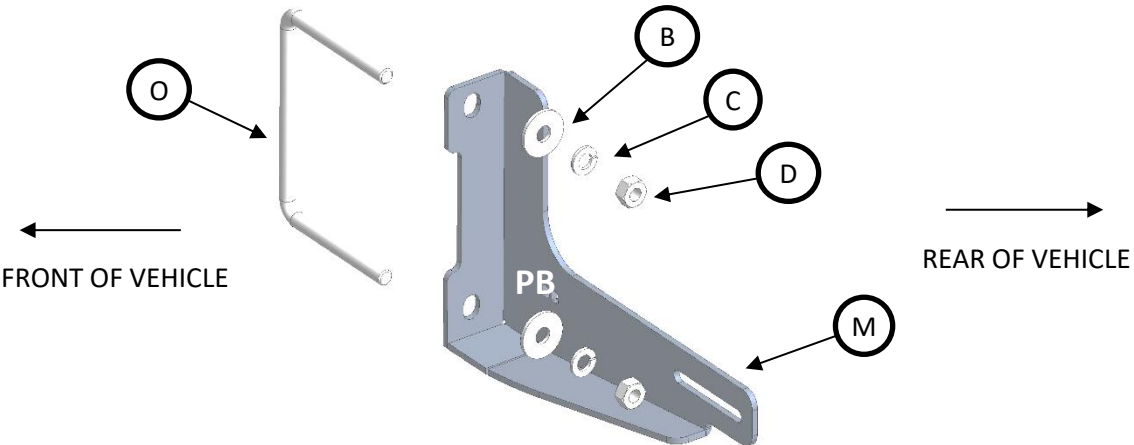
Visual / Graphic Illustration	Step #	Description/Method
 <p><i>Fit Rear Bracket around Chassis Beam</i></p>  	3	Fit Rear Bracket around Chassis as shown in Figure 2. (<i>Fit as Close to Rear of Vehicle & Do Not Tighten Fully</i>)
	4	Do the same to the other side of the vehicle.

Fitment Instruction:

Suzuki Jimny Side Bars

Visual / Graphic Illustration

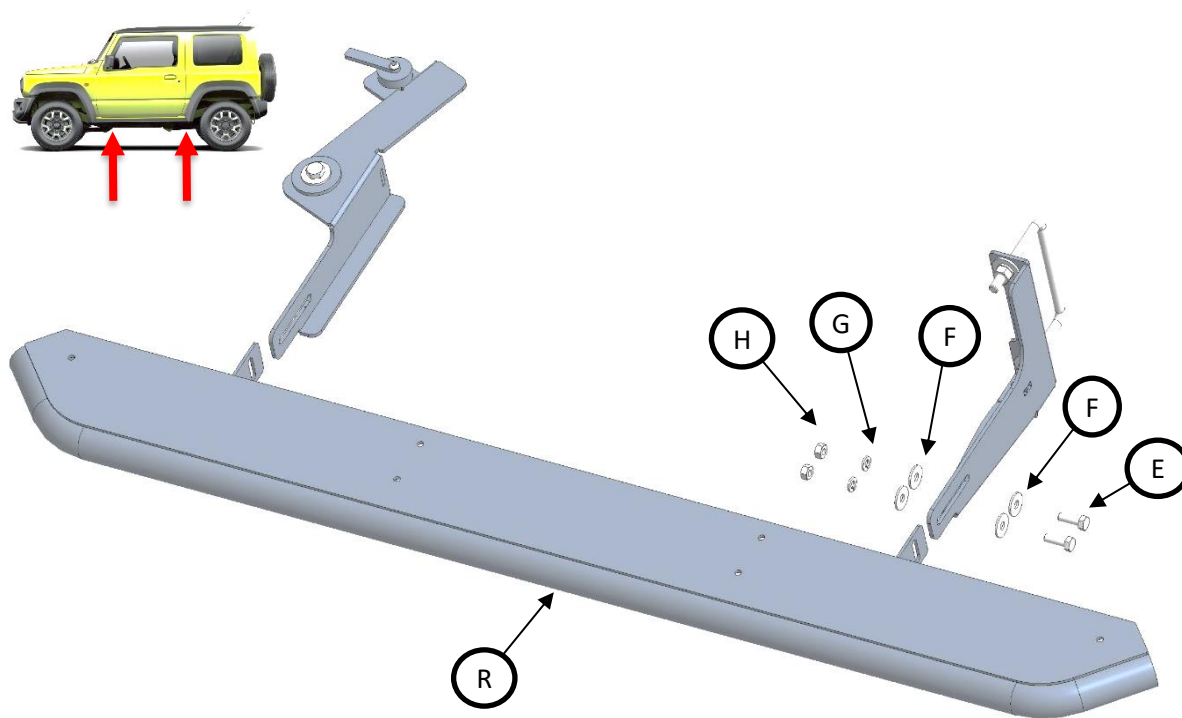

Note: Product Images in the Fitting Instruction might differ from actual product

Step

Description/Method

5

Fit Passenger Side Side Step to Mounted Brackets as shown in Figure 3.

6

Do the same to the other side of the vehicle.

Final step

Page 6 of 6

Make sure bar is centralised and tighten all fasteners to specified torque. M8= 22Nm , M10= 42Nm , M6= 9Nm.

