

# ACCESSORY FITMENT

**Product**

Raptor Nudge bars Top Support brackets

**Part no.**

TSBK-150058 (548)



60  
Minutes

Models : 2023+

Page 1 of 5

Date : 14-03-2024

## DIAGRAM

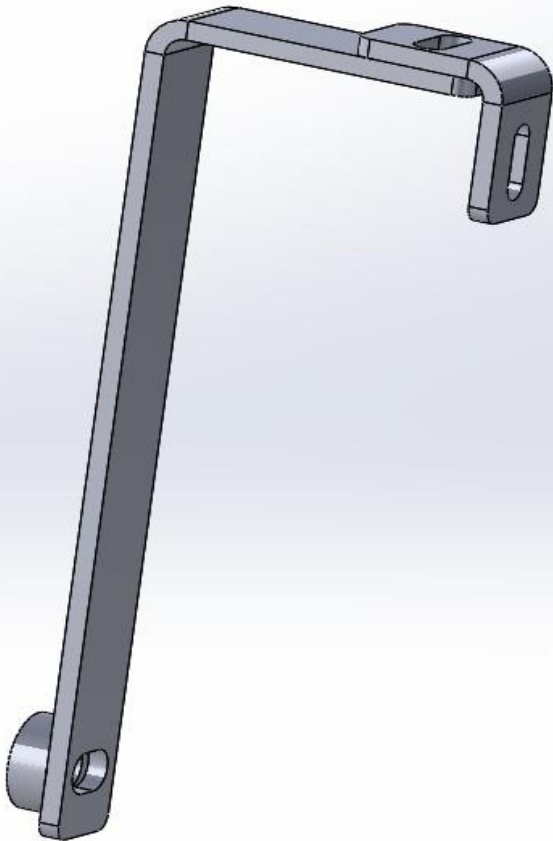

## Kit content:

	Qty	Description		Qty	Description
A	2	M12 x 50 sets	L		
B	2	M12 x 30 x 2.5 flat washers	M		
C	2	M12 Spring washer	N		
D	4	M8 x 30 Sets	O		
E	6	M8 x 22 x 2 Fender washers	P		
F	4	M8 Spring washers	Q		
G	2	M8 Hex Nuts	R		
H	2	M8 Black caps	S		
I	2	M12 Spacers	T		
J	2	Main support brackets	U		
K	2	bolt on tabs	V		
Qty			Qty		
		RATCHET & SOCKET SET			
		Screwdriver set			

## Precautions during fitment:

Do not cause any damage to the vehicle. Apply masking Tape to the front bumper prevent any scratches. Requirs 2 people to fit. Ensure that you are wearing the appropriate PPE during Fitment.

## Directions for use:

Read all instructions carefully before installation

## Fitment Instruction: RAPTOR Top Support Brackets

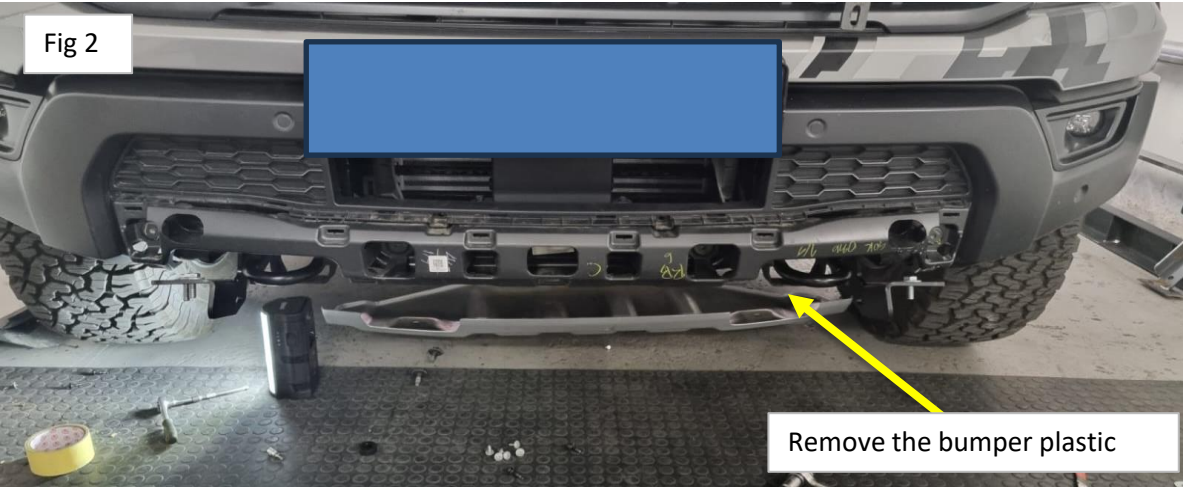
Visual / Graphic Illustration	Step #	Description/Method
 <p>Fig 1</p>	<p>1</p>	<p>Open the top grill cover so you can access the mounting points behind the grill and remove the bottom bumper plastic as shown in Fig 2 so that you can tighten the brackets easier.</p>
 <p>Fig 2</p> <p style="text-align: right;">Remove the bumper plastic</p>		

## Fitment Instruction: RAPTOR Top Support Brackets

Visual / Graphic Illustration

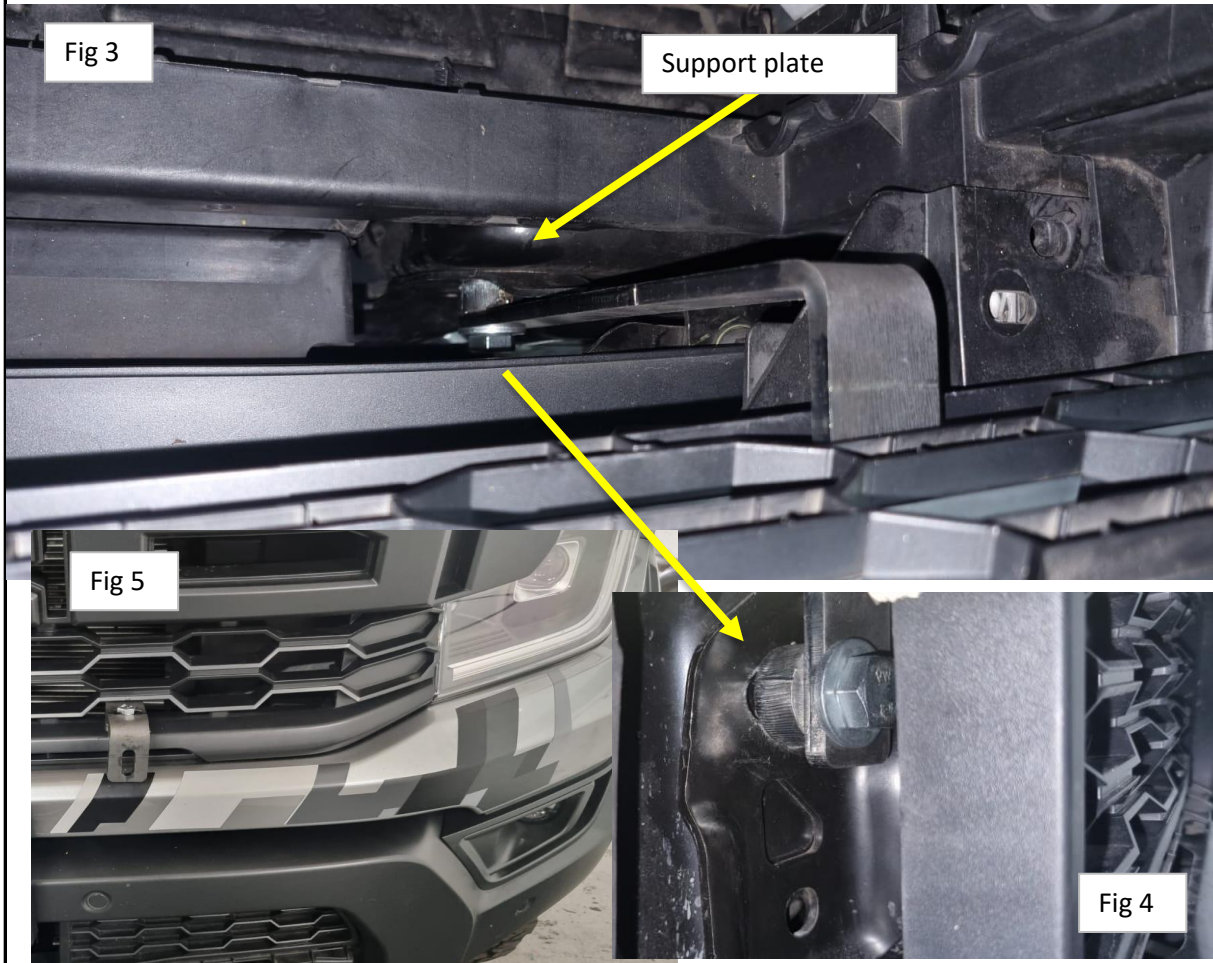

2

Locate the support plate behind the grill as shown in Fig 3.

3

Remove the mounted bolt and loosely fit the spacer and main support bracket as shown in Fig 3 using the same mounting point and the M12 fasteners. Fig 4 shows the mounting point clearly.

4

Allow the main support bracket to protrude out of the grill as shown in Fig 5. Then loosely mount the Bolt on tab using the M8 fasteners

## Fitment Instruction: RAPTOR Top Support Brackets

Visual / Graphic Illustration

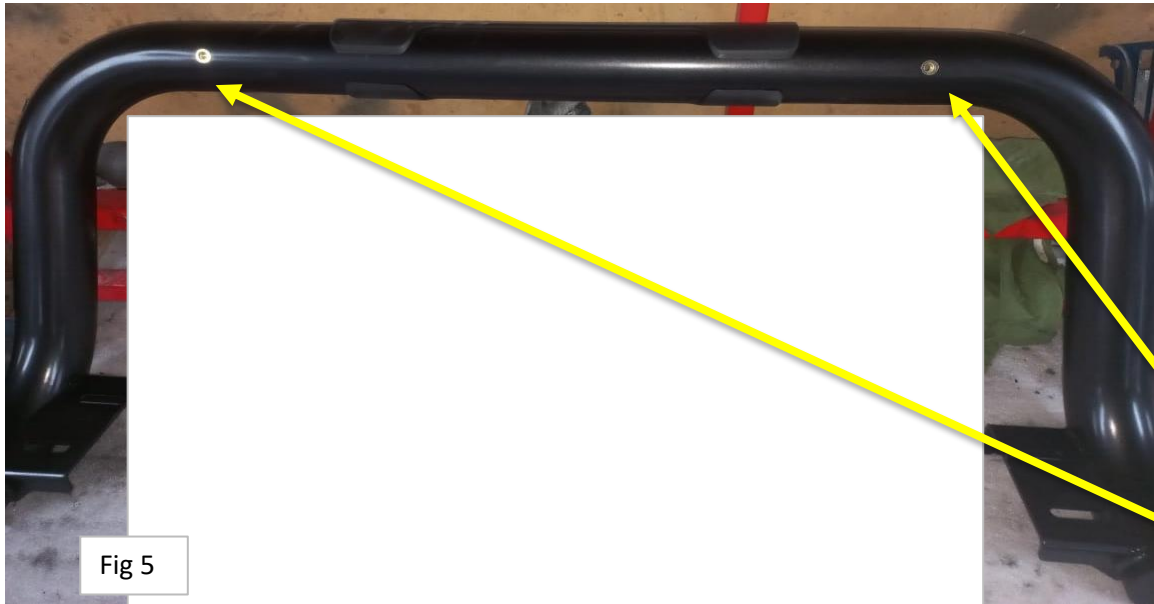

4

Use the mounting points at the top of the nudge (Fig 5) to secure the top support brackets with the M8 fasteners provided.





Make sure bar is centralised and tighten all fasteners to specified torque. M8= 22Nm , M10= 42Nm , M6= 9Nm.



Once the fitment is complete you can pop on the black caps on the M8 bolts at the top.